

2021 Academic Year

**Graduate School of System Design and Management,
Keio University
Master's Program and Doctoral Program**

Course Registration Guide

Keio University



(As of September 2021)

Content

What makes an SDM education unique?	1
Diploma policy, Curriculum policy, Admissions policy	1
SDM Academic Calendar	3
Class Periods	5
Handling of Classes in Emergencies	5
Handling of Classes During Waseda-Keio Baseball Games and the Mita Festival	5
Class Attendance when Chosen as a Lay Judge	5
School Holidays	5
Web Systems	6
1. General Information (Master's/ Doctoral).....	9
1-1. Graduate School of System Design and Management, Hiyoshi Office of Student Services (SDM Office)	
1-2. Notifications for Students	
1-3. Student ID Number	
1-4. Student ID Card (Security Card)	
1-5. Classrooms	
1-6. Security	
1-7. Class Schedules and Syllabi	
1-8. Cancellations and Make-up Classes	
1-9. Examinations and Grades	
1-10. Lockers	
2. Applications and Notifications (Master's/ Doctoral).....	12
2-1. Temporary Leave of Absence	
2-2. Withdrawal	
2-3. Studying Abroad (Articles 124 of the Graduate School Rules)	
2-4. Period of Enrollment in the Doctoral Program	
2-5. Changes to Personal Information of the Student/Guarantor	
2-6. Payment of Academic Fees and Expenses and Deferred Payments	
2-7. Use of Classrooms	
2-8. Off-campus Student Activities	
2-9. Parking Permit	
2-10. Cafeteria	
2-11. Filming and Taking Photographs on Campus	
2-12. Posters and Pamphlets	
3. Certificates (Master's/ Doctoral).....	17
3-1. Certificate of Expected Completion	
3-2. Certificate of Annual Health Examination	
3-3. Student Travel Fare Discount Certificate	
4. Scholarships (Master's/ Doctoral).....	18
5. Annual Health Check, Student Health Insurance, Counseling and Career Support (Master's/ Doctoral).....	19
5-1. Annual Health Check	
5-2. Notification of Infectious Diseases	
5-3. Keio Student Health Care Mutual Aid Association	
5-4. Personal Accident Insurance for Students pursuing Education and Research with the Additional Coverage for Commuting Accidents	

5-5. Optional Compensation	
5-6. Student Counseling Room	
5-7. Keio University Harassment Prevention Committee	
5-8. Lost and Found	
5-9. Placement and Career Services	
5-10. Access to the Networks	
6. Curriculum and Process for Degree Completions (Master's Program).....	22
6-1. Courses	
6-2. Requirements for Completion of Degree	
6-3. Course Registration	34
6-3-1. Course Registration	
6-3-2. Course Registration Procedure	
6-3-3. Course Registration Schedule	
6-3-4. Notes	
6-3-5. "Subject Number" Column	
6-3-6. Inquiries on the Curriculum	
7. Curriculum and Process for Degree Completions (Doctoral Program).....	40
7-1. Required Course	
7-2. Requirements for Completion of Degree	
7-3. Course Registration	43
7-3-1. Course Registration	
7-3-2. Course Registration Procedure	
7-3-3. Course Registration Schedule	
7-3-4. Notes	
7-3-5. "Subject Number" Column	
7-3-6. Inquiries on the Curriculum	
Layout of Third Floor of Collaboration Complex	48
Layout of Sixth Floor of Collaboration Complex	48
Campus Map	49

Due to countermeasures against infectious diseases, our current correspondence may be different from several descriptions in this Course Registration Guide. (ex. SDM office hours)

Please check SDM website (For students), Keio University Student website, keio.jp news, etc.

Keio's response measures to the Pneumonia Associated with the 2019 Novel Coronavirus (For Students)

<https://www.students.keio.ac.jp/en/com/class/schedule/covid-19.html>

What makes an SDM education unique?

At the Graduate School of System Design and Management (SDM), we nurture students who can lead the world with ambitious new ideas. Specifically, as systems designers who aptly design advanced large-scale technological systems that are complex, innovative, and versatile; as project leaders who manage large-scale projects with multiple participants; and as social designers who set forth novel social systems for highly uncertain and volatile environmental and social problems. We train students to create new systems in various fields using leading-edge systems design research from across disciplines and education delivered via detailed courses grounded in systems engineering and innovative design.

Students in the master's program acquire general design and management expertise in the Core Subjects that include strategic systems engineering methods and communications skills. In the "Design Project" course, they work on the concept design of innovative systems. Students can also take a variety of courses that deepen their expertise, polish their skills, and cultivate a global perspective. In the "Research on System Design and Management" Special Research Subject (master's thesis), they write a thesis on their research over the two-year enrollment period (standard) and the findings they have published both in Japan and internationally. Students are also encouraged to participate in group research projects, which gives them an opportunity to work together with other students and the numerous faculty members at our various laboratories (research units).

Although the doctoral program is centered on research, students are strongly encouraged to take the Core and Project Subjects to ensure their mastery of basic system engineering, system design, and management.

Diploma policy

Both the master's and doctorate programs have degrees in "System Engineering" and "System Design and Management."

Completion of studies for the **Master of System Engineering** means that students learn the core subjects and project subjects, and after studying other courses to acquire a broader global perspective, compile their research in fields primarily related to the design of technological systems into a master's thesis. Completion of studies for the **Master of System Design and Management** means that students learn the core subjects and project subjects, and after studying other courses to acquire a broader global perspective, compile their research in fields primarily related to solving problems in social systems into a master's thesis.

Completion of studies for the **Doctor of System Engineering** means that students have academic papers in fields primarily related to the design of technological systems positively evaluated by specialists, or have a system they created positively evaluated by specialists, compiling the outcomes of which into a doctoral dissertation. Completion of studies for the **Doctor of System Design and Management** means that students have academic papers in fields primarily related to solving problems in social systems positively evaluated by specialists, or have a system they created positively evaluated by specialists, compiling the outcomes of which into a doctoral dissertation.

Curriculum policy

On the master's program, students will master comprehensive management skills including strategic system engineering methods and communication skills in core subjects, and work on a "design project" course embracing jitsugaku or practical learning. In addition, we offer a variety of courses for students to acquire a broader global perspective.

For the master's program in System Engineering, students primarily engage in research over a two-year period (standard) in fields related to the design of technological systems, presenting their findings, etc., in Japan and internationally and compiling these into a master's thesis. **For the master's program in System**

Design and Management, students primarily engage in research over a two-year period (standard) in fields related to addressing issues in social systems, which they then compile as a master's thesis.

On the doctoral programs, it is possible for students to take courses taught as part of the master's programs in order to study required subjects (especially core subjects, etc.). **For the doctoral program in System Engineering**, students primarily engage in research over a three-year period (standard) in fields related to the design of technological systems, on which they compile a doctoral dissertation while being positively evaluated by external specialists through presenting their findings in Japan and internationally. **For the doctoral program in System Design and Management**, students primarily engage in research over a three-year period (standard) in fields related to solving problems in social systems, on which they compile a doctoral dissertation while being positively evaluated by external specialists through presenting their findings in Japan and internationally.

In all of the degree programs, students can take lectures given by renowned professors from overseas while still in Japan through SDM's collaborations with MIT, Montclair State University, TU Delft, INSA, Politecnico di Milano, and others. In addition, we actively implement student exchange programs with all these universities. Due to the wide range of issues tackled by SDM, students conduct research while eliciting guidance from various related parties, which they compile into a thesis or dissertation.

Admissions policy

For the master's programs, we admit both persons aspiring to conduct research and put into practice the design and engineering of innovative technological systems that will contribute to resolving many of the large-scale and complex issues of the modern day, and those aspiring to research on and implement the leadership and management required to propose solutions to issues in the diverse social systems of today and guide these projects to success. In order to foster personnel befitting of these degrees, we admit people from many walks of life, including persons advancing to graduate school directly after completing their bachelor degrees and those with hands-on experience (early career/seasoned professionals) at organizations in the public, private, and other sectors. Screenings are conducted to comprehensively assess whether candidates have sufficient aptitude, skillsets, and desire to actively study alongside students from diverse backgrounds and put what they learn to practical use in the real world.

For the doctoral programs, we admit both persons aspiring to support various fields as researchers and social practitioners through advanced academic research on the design and engineering of innovative technological systems that will contribute to resolving many of the large-scale and complex issues of the modern day, and those aspiring to contribute to various fields as researchers and social practitioners through proposing solutions to issues in the diverse social systems of today and advanced academic research on the leadership and management to guide these projects to success. In order to foster personnel befitting of these degrees, we admit people from a wide range of spheres across generations, including persons with hands-on experience in the public and private sectors (early career/seasoned professionals) as well as students who have completed a master's degree program. Screenings are conducted to comprehensively assess whether candidates possess academic and research capabilities equivalent to those required for the master's program, the initiative to plan and conduct research, and sufficient aptitude, skillsets, and desire to put what they learn to practical use in society as specialists, in addition to whether they have made the preparations necessary to pursue their research after admission.

AY 2021 SDM Academic Calendar

Numbers “① to ⑭” show the order of class sessions and the corresponding days. An extra session may be held depending on the progress of classes. Please follow the instructions of the lecturer in charge of each course.

“DP” indicates the days when “Design Project” classes are held.

	Sun	Mon	Tue	Wed	Thu	Fri	Sat	
Apr						1 Entrance Ceremony/ Kyosei-kan walking tour	2 Course Registration (First time) Online Boot Camp (21S)	
	4	5	Course Registration (Second time)	6 DP (E)	7	8	9 DP (J)	
	①Classes begin	①		①		①	①	
	Course Registration (Second time)	11	12	13	Course Registration (Second time)	14	15	16
	②Submission of tentative supervisor request	②	②		②		②	②
	18	19	20	21	22	23 DP	24	
③	③	③	③	③	③Keio foundation Day	③		
25	26	Modification for Course Registration	27	28	29	30		
④	④	④	④	④Showa Day	④			
May							1	
	2 DP	3 DP	4	5	6	7 DP	8	
	Constitution Day	Greenery Day	Childrens Day	⑤	⑤	⑤	⑤	
	9	10	11	12	13	14	15	
	⑤	⑤	⑤	⑥	⑥	⑥	⑥	
	16	17	18	19	20	21 DP	22	
⑥	⑥	⑥	⑦	⑦	⑦	⑦		
23	24	25	26	27	28	29		
⑦	⑦	⑦	⑧	⑧	Secondary Advisor assigned (19F RI/LI)	⑧		
30	31							
⑧								
Jun			1	2	3	4 DP	5	
			⑧	⑧	⑨	⑨	⑨	
	6	7	8	9	10	11	12	
	Application for tentative Master's Thesis Title (1F RI/LI)	⑨	⑨	⑩	⑩	⑩	⑩	
	13	14	15	16	17	18 DP	19	
	⑩	⑩	⑩	⑪	⑪	⑪	⑪	
20	21	22	23	24	25	26		
⑪	⑪	⑪	⑫	⑫	⑫	⑫		
27	28	29	30					
⑫	⑫	⑫						
Jul					1	2 DP	3	
					⑬	⑬	⑬	
	4	5	6	7	8	9 DP	10	
	Application for degree examination (D)	⑬	Acceptance of application for degree examination and establishment of the examination committee (D)	⑭	⑭	Submission of Master's Thesis(19F RI/LI)	⑮	
	11	12	13	14	15	16 DP	17	
	⑭	⑭	⑭	⑮	⑮	Exam of Master's Thesis (19F RI/LI)	⑮	
18	19	20	21	22	23	24		
⑮	⑮	⑮	⑮	Marine Day	Olympics	Olympics		
25	26	27	28	29	30 DP	31		
Olympics	Olympics	Olympics	Olympics	Olympics	Olympics	Olympics		
					Health and Sports Day			
Aug	1	2	3	4	5	6	7	
	Olympics	Olympics	Olympics	Olympics	Olympics	Olympics	Olympics	
	8 DP	9	10	11	12	13	14	
	Mountain Day	Substitute Holiday					Reexam of Master's Thesis (objective students only)	
	15	16	17	18	19	20	21	
22	23	24	25	26	27	28		
Submission of Master's Thesis(Final ver) (19F RI/LI)	Paralympics	Paralympics	Paralympics	Paralympics	Paralympics	Paralympics		
29	30	31						
Paralympics	Paralympics	Paralympics						
Sep				1	2	3	4	
				Paralympics	Paralympics	Paralympics	Paralympics	
	5	6	7	8	9	10	11	
	Paralympics		Due date: asking questions regarding grade				Theme Presentation (21S RI/20S LI)	
	12	13	14	15	16	17	18	
						Interim Presentation (20S RI/20F RI)	Commencement Ceremony Research Presentation (Fall D)	
19	20	21	22	23	24	25		
	Respect for the Aged Day		Entrance Ceremony/ Distribute textbooks	Autumn Equinox Holiday		Online Boot Camp (21F)		
26	27	28	29	30				
Course Registration (1)	Submission of tentative supervisor request			Course Registration (2)				

	Sun	Mon	Tue	Wed	Thu	Fri	Sat
Oct						1 Course Registration (2) ①Classes begin	2 ①
	3	4	5	6	7	8 →Course Registration (2) ②	9
	①	①	①	①	①	②	②
	10	11	12	13	14	15	16
	②	②	②	②	②	③	③
	17	18	19	20	21 Modification for Course Registration	22	23
	③	③	③	③	④	④	④
24	25	26	27	28	29	30	
④	④	④	④	④	⑤	⑤	
31							
Nov		1	2	3 ⑤Culture Day	4	5	6
	⑤	⑤	⑤	⑤	⑥	⑥	⑥
	7	8	9	10	11 Secondary Advisor assigned (20S RI/LI)	12	13
	⑥	⑥	⑥	⑥	⑦	⑦	⑦
	14	15	16	17	18	19	20
⑦	⑦	⑦	⑦	⑧	⑧	⑧	
21	22	23 ⑧Labour Thanksgiving Day	24	25	26	27	
⑧	⑧	⑧	⑧	⑨	⑨	⑨	
28	29 Application for tentative Master's Thesis Title (20S RI/LI)	30					
⑨	⑨	⑨					
Dec				1	2	3	4
				⑨	⑩	⑩	⑩
	5	6	7	8	9	10	11
	⑩	⑩	⑩	⑩	⑪	⑪	⑪
	12	13	14	15	16	17	18
⑪	⑪	⑪	⑪	⑫	⑫	⑫	
19 Power Outage	20 Application for degree examination (D)	21	22 Acceptance of application for degree examination and establishment of the examination committee (D)	23	24	25	
⑫	⑫	⑫	⑫	⑬	⑬	⑬	
26	27	28	29	30	31		
⑬							
Jan							1 New Year's Day
	2	3	4	5	6	7	8
				⑬	⑭	⑭	⑭
	9 Coming-of-age Day Yukichi Fukuzawa's Birthday	10	11	12	13	14	15
	⑭	⑭	⑭	⑭	⑮	⑮	⑮
	16	17	18	19	20	21 Submission of Master's Thesis(20S RI/LI)	22
⑮	⑮	⑮	⑮	⑯	⑯	⑯	
23	24	25	26	27	28	29	
⑯	⑯	⑯	⑯	⑰	⑰ Exam of Master's Thesis (20S RI/LI)	⑰ Theme Presentation (21F RI/20F LI) Exam of Master's Thesis (20S RI/LI)	
30	31						
Feb			1	2	3	4	5
	6	7	8	9	10 Reexam of Master's Thesis (objective students only)	11 Submission of Master's Thesis(Final ver) (20S RI/LI)	12 Interim Presentation (21S RI/20F RI) Research Presentation (Spring D)
	⑰	⑰	⑰	⑰	⑱	⑱ National Foundation Day	⑱
	13	14	15	16	17	18	19
⑱	⑱	⑱	⑱	⑲	⑲	⑲	
20	21	22	23 Emperor's Birthday	24	25	26	
⑲	⑲	⑲	⑲	⑳	⑳	⑳	
27	28 Submission of doctoral dissertation						
Mar			1	2	3	4	5
	6	7	8	9	10 Sending Grade Report/ Announcement of Completion in March	11	12
	⑳	⑳	⑳	㉑	㉑	㉑	㉑
	13	14	15	16	17	18	19
㉑	㉑	㉑	㉑	㉒	㉒	㉒	
20	21 Vernal Equinox Day	22	23	24	25	26	
㉒	㉒	㉒	㉒	㉓	㉓	㉓	
27	28 Commencement Ceremony	29	30	31			
㉓	㉓	㉓	㉓	㉔			

The following table explains abbreviations used in Academic Calendar.

Admission period	Master's Program Research Intensive	Master's Program Learning Intensive	Doctoral Program	Admission period	Master's Program Research Intensive	Master's Program Learning Intensive	Doctoral Program
April 2019	19S,RI	19S, LI	19S, D	September 2019	19F, RI	19F, LI	19F, D
April 2020	20S, RI	20S, LI	20S, D	September 2020	20F, RI	20F, LI	20F, D
April 2021	21S, RI	21S, LI	21S, D	September 2021	21F, RI	21F, LI	21F, D

<Class periods>

Class periods vary among the campuses, faculties, and graduate schools.

Class Periods	SDM	KMD•KBS	SFC	Mita, Hiyoshi, Yagami, and Shinanomachi Campuses	Shiba-Kyoritsu Campus
Period 1	9:00a.m.-10:30a.m.	9:00a.m.-10:30a.m.	9:25a.m.-10:55a.m.	9:00a.m.-10:30a.m.	9:00a.m.-10:30a.m.
Period 2	10:45a.m.-12:15p.m.	10:45a.m.-12:15p.m.	11:10a.m.-12:40p.m.	10:45a.m.-12:15p.m.	10:45a.m.-12:15p.m.
Period 3	1:00p.m.-2:30pm	1:00p.m.-2:30p.m.	1:00p.m.-2:30p.m.	1:00p.m.-2:30p.m.	1:00p.m.-2:30p.m.
Period 4	2:45p.m.-4:15p.m.	2:45p.m.-4:15p.m.	2:45p.m.-4:15p.m.	2:45p.m.-4:15p.m.	2:45p.m.-4:15p.m.
Period 5	5:15p.m.-6:45p.m. 4:30p.m.-6:00p.m. *for classes held continuously for the 4th to 5th period, etc.	4:30p.m.-6:00p.m.	4:30p.m.-6:00p.m.	4:30p.m.-6:00p.m.	4:30p.m.-6:00p.m.
Period 6	7:00p.m.-8:30p.m.	6:10p.m.-7:40p.m.	6:10p.m.-7:40p.m.	6:10p.m.-7:40p.m.	6:30p.m.-8:00p.m.
Period 7	—	KBS7:50p.m.9:20p.m	7:50p.m.-9:20p.m.	7:50p.m.-9:20p.m.	8:00p.m.-9:30p.m.

The times for the final (semester-end) examinations for undergraduate faculties are subject to change.

<Handling of Classes in Emergencies>

In cases where either the government or the Japan Meteorological Agency issues a Tokai Earthquake Warning, transport services such as rail are discontinued due to a large-scale accident or because of natural disasters, or in the event of any other emergency situation leading to the cancellation of classes, an announcement will be made via the “Keio University Students website” stated below and the SDM home page:

Handling of Classes in Emergencies <https://www.students.keio.ac.jp/en/com/class/schedule/emergency.html>

[Important notes]

If an emergency occurs after the start of classes, separate measures, such as sending students home early or shortening the duration of lectures, will be taken as circumstances dictate. Follow the instructions that are given via the campus broadcasts and put up on the bulletin boards and websites stated above.

<Handling of Classes during Waseda-Keio Baseball Games and the Mita Festival>

Classes at SDM will take place as usual during Waseda-Keio baseball games and the Mita festival.

<Class Attendance when Chosen as a Lay Judge>

Keio University does not officially recognize absences from classes to attend a trial as a lay judge. Students who are selected as lay judges and are unsure about class attendance should consult with a staff member at the SDM Office. Please note that the nature of certain classes may mean that attendance is compulsory.

<School Holidays>

Classes will not take place on the following days (hereafter referred to as “school holidays”). However, school holidays may be changed or classes temporarily suspended when necessary.

Sundays	
Public Holidays	
Anniversary of Yukichi Fukuzawa’s Birthday	(January 10)
Keio Foundation Day	(April 23)
Summer Break	(from late July to late September)
Winter Break	(from late December to early January)
Spring Break	(from mid-March to late March)

Web Systems

1. Overview

“For SDM Students” website	
URL	http://www.sdm.keio.ac.jp/en/student/
ID/Password	Common ID and password * If you lose your password, you can check it from “Information” on the TOP page of SDM e-learning system.
Overview	This portal website provides a variety of information to SDM students.

SDM e-learning System	
URL	https://archiver.sdm.keio.ac.jp/cgi/e-student/login.cgi
ID/Password	Student Number, Date of Birth, and password * If you lose your password, you can check it from the login screen of the e-learning system.
Overview	This system allows students to view SDM e-learning courses. E-learning courses are recommended to students who have a strong desire to register a course, but have difficulty attending classes on campus. Class videos and syllabi are available on the website.
Main services	<ul style="list-style-type: none"> ■ e-learning In addition to viewing class videos, the system allows students to submit assignments, ask questions to the lecturers, and exchange opinions with others through a BBS (bulletin board). <ul style="list-style-type: none"> ■ Access to syllabi SDM course syllabi are available for viewing.

Keio University Student website	
URL	https://www.students.keio.ac.jp/en/
Overview	This portal website provides a variety of information to Keio students (information is provided partly in English).
Main services	<ul style="list-style-type: none"> ■ Classes, course registration, examination Course Registration Guide, Syllabi, Timetable (PDF), etc. <ul style="list-style-type: none"> ■ Student life, career support Information on the SDM Office, events, and scholarships

Common Authentication System (keio.jp)	
URL	http://keio.jp/
ID/Password	Keio ID and password *If you have lost your ID or password, please visit the Hiyoshi ITC with your student ID card.
Overview	This website allows you to access a variety of services with your Keio ID. Students must activate their Keio ID before using this website.
Manual	http://www.hc.itc.keio.ac.jp/en/keiojp_manual.html

Main services	<p>■ Course registration</p> <p>This system allows students to register, amend, and confirm registered courses during the designated online course registration periods. You can make changes at any time during the designated period. Please refer to the online course registration schedule. Please also check the timetable frequently as it is subject to change and you may need to amend your registered courses accordingly.</p> <p>■ Confirmation of Registered Courses</p> <p>This page provides a list of courses you have registered. The list is only available during a designated period. Please note that the list displayed on the website is not a finalized list, but a tentative version.</p> <p>■ Confirmation/Change of Address</p> <p>You can check your and your guarantor's contact details. If they change, update the information via this system. (See 2-5. Changes to Personal Information of the Student/Guarantor.)</p> <p>■ Academic transcript</p> <p>This website allows students to view their academic transcript. The period transcripts are available on the website is designated by each department or graduate school. Detailed information will be announced on the "Keio University Students website".</p> <p>■ Result of health check</p> <p>Results of the health check is available for students who took the health check. We will notify you of the period you can view your result when you take the health check. Contact the Health Center for any questions you may have regarding the results.</p> <p>■ Placement and Career Services System</p> <p>Information on career consultation, submission of the Plans after Graduation, student job search reports, job offers, etc., can be found.</p>
---------------	---

2. Notes on Using the Online Systems

- Do not log in simultaneously on multiple browsers.
- Do not use the browser's "back" or "forward" buttons after logging into the online system. If you mistakenly click the "back" or "forward" button and the screen does not display properly, close the browser, wait ten seconds, and launch the browser again.
- If the same screen is displayed for a prolonged period of time, the system will not allow you to move on to the next screen for security reasons. If this happens, close the browser, wait ten seconds, and launch the browser again.
- If your name contains complex characters, they may not be displayed properly on the screen. Please note that this is not a problem with the system itself.
- You may not be able to log into the online system without the recommended environment and settings (cookies, SSL, proxy, etc.). See the online system manual for recommended environments, settings, and operations.

3. Password reissuing

The following are the contact points for reissuing Web system passwords.

	Login ID	Login password	Reissued by	Required documents
Web "For SDM Students"	Common ID	Common password	TOP page of SDM e-learning system	--
SDM e-learning system	Student Number and Date of Birth	password	The login screen of the e-learning system	--
Web "To Keio Students"	N/A	N/A	--	--
"keio.jp"	Keio ID	keio.jp password	Hiyoshi ITC	Student ID card

1. General Information (Master's/ Doctoral)

1-1. Graduate School of System Design and Management, Hiyoshi Office of Student Services (hereafter referred to as the “SDM Office”)

The SDM Office is located on the second floor of the Collaboration Complex at Hiyoshi Campus. This office handles requests for applications, notices, and certificates not available at the Certificate Issuing Machines; procedures for course registration and academic transcripts; scholarship applications; and career services. Students must ensure that they strictly observe the dates and times for submission deadlines. Under no circumstances will submissions be accepted after the prescribed deadlines.

Office hours: Monday to Friday from 8:45 a.m. to 4:45 p.m.

*The office is closed from 11:30 a.m. to 12:30 p.m. outside of the regular class periods.

*The office is closed on weekends, public and Keio University holidays, and during periods when the university administration is on break.

Operating Hours of Certificate Issuing Machine: Monday to Saturday* from 8:45 a.m. to 8:15 p.m.

*Only in operation on Saturdays during periods when classes are held at KBS, SDM, and KMD.

*Not in operation on Sundays, public holidays, designated university holidays, or during break periods of the Office of Student Services (Graduate Schools), Hiyoshi Campus, and periods when the machines are being serviced.

1-2. Notifications for Students

Students should check the notifications posted on the SDM website in the “For Students” section on a daily basis (<http://www.sdm.keio.ac.jp/en/student/>). Students who fail to check the website regularly will be at a disadvantage if they miss important notifications. Additionally, students should check the bulletin boards or website (keio.jp, etc.) of other graduate schools and faculties if registered for their courses. Check the common bulletin boards or website (keio.jp, etc.) for information regarding the lectures and courses offered at the various Research Centers and Institutes.

1-3. Student ID Number

The eight-digit number shown on the front of the student ID card and the registration sticker on the back is your student ID number. Each student is assigned a unique number, which is used for all procedures at the university including course registration and the submission of any documentation.

1-4. Student ID Card

The student ID card is your proof of enrollment at SDM. It also serves as a security card for accessing certain areas of the Collaboration Complex, as a library card, and as proof of membership of the Keio Student Health Care Mutual Aid Association (Gakuseikenpo). The student ID card shall neither be leased nor be transferred. The student ID card is only valid once the registration sticker is attached to the back of the card.

Students should carry their student ID cards at all times as it will be required in the following cases:

- As and when requested by faculty and staff members
- To collect Certificates
- To take exams
- To enter classrooms

- When purchasing student commuter passes or discounted tickets and when requested by transport staff

A. Procedures to issue (renew) registration stickers

Registration stickers are renewed every April or September (only when the expiry date is September 21). Be sure to remove the old registration sticker before attaching the new one. The new stickers will be mailed to students in early March or early September. However, students who have yet to pay their academic fees and expenses for the previous semester will not be issued with a new registration sticker. This will only be issued when they bring the receipt of the money transfer for tuition fees to the SDM Office. (A student ID card without a valid registration sticker attached is void.) Students who have lost the receipt for the money transfer should get confirmation of payment from the Accounting Section at the Hiyoshi Management Service Center.

B. Reissuing Student ID cards

In cases of loss or damage to your student ID card or registration sticker, apply to have the card or sticker reissued by submitting the “Application for Re-issuance of Student ID Card” (学生証再交付願) to the SDM Office.

Necessary items:

- Photograph taken within the last 3 months (A 4×3 cm photo printed on glossy paper without a border. The photo should be of the upper body taken from the front, without a hat and against a plain background.)

Cost to re-issue: 2,000 yen (purchase certificate stamps [shoshi] at the SDM Office)

If the old student ID card is found after a new card has been issued, it should be handed into the SDM Office immediately. Students must also return their student ID cards to the SDM Office if leaving the school due to withdrawal from the university, completion of the degree, or withdrawal from the doctoral program upon completion of the course requirements (without submission of a dissertation).

1-5. Classrooms

For the location of the classrooms and research offices, refer to “Layout of Third Floor of Collaboration Complex” at the end of this guide. For information on reserving classrooms, see “8. Use of Classrooms” in the “Application and Notifications” section below.

1-6. Security

Students may enter the office area (location of certificate issuing machine) outside office hours by holding their student ID cards over the security sensor to the left of the automatic door. Below are the times when the door is locked/unlocked.

<Times locked/unlocked>

-Unlocked: Weekdays, 8:45 a.m. - 4:45 p.m.

-Locked: Weekdays, 7:15 a.m. -8:45 a.m./4:45 p.m. -9:45 p.m.

Saturday, 7:15 a.m. - 9:45 p.m.

Entry is not permitted outside of the above hours (9:45 p.m. - 7:15 a.m.), on Sundays, or during public holidays.

*The Third Floor of Collaboration Complex is locked for 24 hours.

1-7. Class Schedules and Syllabi

The timetable for each semester is available on the SDM website.

“Registration Guides, Lecture Outlines, Timeslots” <http://www.sdm.keio.ac.jp/en/student/guides/>

The syllabi are available on the SDM e-learning system.

1-8. Cancellations and Make-up Classes

In principle, a make-up class will be held whenever the cancellation of a class is unavoidable. The SDM Office will announce all class cancellations and make-up classes on the SDM website.

“Class Cancellations/Make-up Classes Information” <http://www.sdm.keio.ac.jp/en/student/class-info/>

1-9. Examinations and Grades

A. Examinations

Examinations may be held during classes. Students must check the SDM website and the SDM e-learning System for important notifications on examinations to ensure they do not miss any announcements made outside of class.

Semester-end examinations for courses offered by other graduate schools and undergraduate faculties may be held at specified times at the end of the semester. Please note that the examination dates of other Keio graduate schools and faculties are different to those of SDM. For more information, please check the relevant bulletin boards or website (keio.jp, etc.) of the schools and faculties.

B. GPA (Grade Point Average)

If the student entered the university on or after April 1, 2017, his/her grade point average (GPA) will be shown on the Transcript of Academic Record. The GPA is a number expressing the average value of the grades earned in courses. The five grade levels for all registered courses are converted into a grade point (GP) from 4.0 to 0 (S: 4.0, A: 3.0, B:2.0, C: 1.0, D:0.0) and multiplied by the number of credits for the course. The sum of this calculation is then divided by the total number of credits for registered courses.

$$\text{GPA} = \frac{\text{Sum of (Number of Course Credits} \times \text{Grade Point of Course)}}{\text{Total Number of Credits for Registered Courses}}$$

Courses graded as P, F or G and optional courses not required for graduation are excluded when calculating the GPA.

C. Academic Transcripts

Academic transcripts are available in early September for the Spring Semester and in early March for the Fall Semester. Grade reports will not be mailed from the AY2021 onward. Please check through the Online Grade Report instead. Click on [学業成績表 (Grade Report)] on the keio.jp main menu.

The grades of completed courses will be shown on your Transcript of Academic Record from the next semester.

1-10. Lockers

The lockers for SDM master's students are located by the security door on the third floor of the Collaboration Complex. Students must ensure they use the locker with their name tag attached and are personally responsible for preparing the lock.

The area where the lockers are located is for shared use and students are strictly prohibited from leaving any personal belongings in front of the lockers.

The lockers for doctoral students are located in front of the SDM Laboratory (C3N17). Since availability is limited, interested students should apply at the SDM Office.

2. Applications and Notifications (Master's/ Doctoral)

2-1. Temporary Leave of Absence

In the event of a prolonged absence due to illness or other unavoidable reasons, an application for leave of absence countersigned by your guarantor may be submitted. (In accordance with Article 125 of the Graduate School Rules.)

A. Submission of the “Application for Temporary Leave of Absence” (休学願)

Students who wish to take a leave of absence from the university must fill in the “Application for Temporary Leave of Absence,” receive a signature from their guarantor, have an interview with their research advisor, and then submit the application to the SDM Office. The application will not be accepted if the signatures of the student and the guarantor are the same. If you go abroad to attend a language school, you must also submit an acceptance letter from the school in question.

The period for the temporary leave of absence does not count toward the necessary period of enrollment at the graduate school for completion of the degree program. Students must follow the instructions below when submitting an application.

1. Submission Deadline:

The application must be submitted to the SDM Office by May 31 for the Spring Semester and by November 30 for the Fall Semester.

2. Period of Temporary Leave of Absence:

An application to take a temporary leave of absence must be submitted every semester.

Maximum period of temporary leave of absence permitted in the Spring Semester:

From April 1 to September 21

Maximum period of temporary leave of absence permitted in the Fall Semester:

From September 22 to March 31

B. Interview with Research Advisor

After completing the Application for Temporary Leave of Absence, the student must make an appointment with his or her research advisor and receive a signature or seal of approval.

C. Submission of the “Notification of Returning to Study” (就学届)

A “Notification of Returning to Study” must be submitted immediately after returning to university. You can download the form from SDM website “For Students”.

If the student takes a temporary leave of absence due to illness, a medical certificate from a doctor must also be submitted with the Notification of Returning to Study.

D. Academic Fees and Expenses during Temporary Leave of Absence

Tuition and facilities fee will be waived.

E. Health Check

If a student takes a temporary leave of absence and is not able to take the annual health check in April, he or she is required to take the health check in September during the orientation period for incoming students.

2-2. Withdrawal

A. Voluntary Withdrawal

Fill in the “Notification for Withdrawal” (退学届) available at the SDM Office. The student and his or her guarantor must sign and affix their seals individually on the form, have an interview with the student’s research advisor, and then submit the form to the SDM Office. The student ID card of the student must also be returned when the form is submitted.

1. Submitting the “Notification for Withdrawal”

The student and his or her guarantor must sign and affix their seals on the form.

*The application form will not be accepted if the signatures or seals of the student and the guarantor are the same.

2. The student must return his or her student ID card upon submitting the form.3. Date of Withdrawal

If tuition and other fees have been paid, students may set the withdrawal date. (Usually September 21 for the Spring Semester and March 31 for the Fall Semester.) Please note that if students choose to withdraw before the end of the semester, they will not receive credits for registered courses in that semester.

B. Expulsion (excerpt from Articles 128 and 161 of the Graduate School Rules)

The maximum period of enrollment in the same graduate school is four years for the master’s program and six years for the doctoral program, excluding any temporary leaves of absence. Disciplinary action will be taken to expel students who are seen to be unmotivated and unfit to pursue a degree from the graduate school.

2-3. Studying Abroad (Article 124 of the Graduate School Rules)

A. Before Going Abroad

The “Application for Study Abroad” (国外留学申請書) must be submitted to the SDM Office two months prior to the desired departure date. After being screened by the student’s research advisor, the application shall be deliberated and approved by the Graduate School of System Design and Management Faculty Committee. Please note that going abroad to attend a language school is treated as a temporary leave of absence.

B. Documents to Submit after Returning

Students must submit the following documents to the SDM Office after returning from abroad. A period of up to one year studying at overseas universities and institutions can be counted toward the enrollment period at the Graduate School of System Design and Management.

- Notification of Returning to Study (就学届)
- Application Regarding Period of Study Abroad (在学期間算入願)

If you wish to transfer credits (maximum of ten credits) acquired abroad to the degree program at SDM, submit the following documents after receiving approval from your research advisor. Students must have the necessary documents issued while studying at the university/institution abroad.

- Application for Accreditation of earned Credits (単位認定申請書)
- Academic transcript
- Course syllabus

2-4. Period of Enrollment in the Doctoral Program

The maximum period of enrollment in the doctoral program is 12 semesters, excluding any temporary leaves of absence. If you have earned credits for all of the required courses by the end of your third year, you can either choose to stay in the program to complete your dissertation or withdraw from the program as a student who has completed the required course work but has not submitted a dissertation (Withdrawal from the Doctoral Program [After the Completion of Required Course Work without Submission of a Dissertation]). Submit the appropriate application (Application for Extension of Enrollment Period or the Notification of Withdrawal from the Doctoral Program with the Completion of

Course Requirements; see below) to the SDM Office.

A. Application for Extension of Enrollment Period

If a student wants to remain enrolled in the doctoral program, an “Application for Extension of Enrollment Period” (在学期間延長許可願) must be submitted to the SDM Office by the end of August for those whose period of enrollment ends in the Spring Semester and by the end of February for those whose period of enrollment ends in the Fall Semester. If the application is approved, the student will be allowed to remain enrolled for up to six additional semesters from the end of the third year, excluding temporary leaves of absence. The student may apply for a tuition waiver for the extended enrollment period.

B. Notification of Withdrawal from the Doctoral Program with the Completion of Course Requirements (所定単位取得退学届)

If students in the doctoral program earn all the necessary credits within three years of enrollment but do not submit a doctoral dissertation, they can submit a “Notification of Withdrawal from the Doctoral Program with the Completion of Course Requirements” to the SDM Office.

2-5. Changes to Personal Information of the Student/Guarantor

Students must update their address/contact details immediately if they change via “Confirmation/Change of Address” on keio.jp. Normally, changes will be approved in a few days. When your home address changes, you need to revise the details on the sticker on the back of your student ID card and receive a stamp from the SDM Office.

When the details of your guarantor change, fill in a designated form at the SDM Office. Please note that submission of the above document is extremely important to prevent delays in receiving any vital documentation that is sent out by the SDM Office in the post.

2-6. Payment of Academic Fees and Expenses and Deferred Payments

Fees for students who admitted in AY 2021

(unit: Japanese yen)

	Registration Fee	Tuition Fee	Student Health Care Mutual Aid Fee	Total
Master's Program	60,000 (30,000)	1,920,000 (960,000)	2,600 (1,350/ 1,250)	1,982,600 (991,350/ 991,250)
Doctoral Program	60,000 (30,000)	1,140,000 (570,000)	2,600 (1,350/ 1,250)	1,202,600 (601,350/ 601,250)

Fees for students who admitted in or after AY 2016

(unit: Japanese yen)

	Registration Fee	Tuition Fee	Student Health Care Mutual Aid Fee	Total
Master's Program	60,000 (30,000)	1,920,000 (960,000)	2,500 (1,250)	1,982,500 (991,250)
Doctoral Program	60,000 (30,000)	1,140,000 (570,000)	2,500 (1,250)	1,202,500 (601,250)

	Registration Fee	Tuition Fee	Facilities Fee	Student Health Care Mutual Aid Fee	Total
Master's Program	60,000 (30,000)	1,500,000 (750,000)	320,000 (160,000)	2,500 (1,250)	1,882,500 (941,250)
Doctoral Program	60,000 (30,000)	750,000 (375,000)	320,000 (160,000)	2,500 (1,250)	1,132,500 (566,250)

*Tuition and other fees can be paid in two installments, in the Spring and Fall Semesters.

(Installment payment amounts are shown in the parentheses.)

Fees must be paid to Keio University by bank transfer. A payment slip will be sent to the student's address in mid-April for the Spring Semester and in early October for the Fall Semester. Please keep the receipt as proof of payment.

<Refer to> **Article 131 of the Graduate School Regulations (Daigakuin Gakusoku)**

Payment Deadline

Payment for the Spring Semester and payment in full: Friday, April 30

Payment for the Fall Semester: Friday, October 29

If tuition and other fees cannot be paid by the deadline due to unavoidable reasons, students must submit the "Application for Tuition Deferment" (延納申請書) to the SDM Office by the following dates:

Spring Semester: Friday, May 14

Fall Semester: Monday, November 15

The reason for payment delay must be approved by Keio University, which will issue a certificate upon approval.

You may download the form from

<https://www.students.keio.ac.jp/en/com/scholarships/tuition/extension.html>

The deadlines for deferred payments are as follows:

Spring Semester: Friday, July 30

Fall Semester: Friday, December 24

2-7. Use of Classrooms

In order to use classrooms for academic meetings, a reservation must be made in advance. For classrooms C3N14 and C3S10 (CDF), reservations must be made at the SDM Office from three days to two weeks prior to the day of use. To use discussion rooms C3N04 to C3N09, fill in the booking form.

Form (<https://docs.google.com/spreadsheets/d/1dltT4iYZjsSaI6WZfriu2F5DYMDcuJp2FOSa3YEUNks/edit?usp=sharing>)

To use discussion rooms C3S03 to C3S09, fill in the booking sheet placed on the door of each room. Draw a line indicating the period you wish to use the room, and write your name beside it. Discussion rooms C3S03 to C3S09 can be used continuously for up to two class periods. Please note that discussion rooms are shared with KMD students.

After using the rooms, clean the room and return the desks and chairs to their original position.

2-8. Off-campus Student Activities

To hold extracurricular activities off campus, a "Notification of Off-campus Student Activities" (学外行事届) must be submitted to the SDM Office four days prior to the activities. Please be aware that without a prior application being

made, medical expenses for accidents and injuries will not be covered by the insurance policy.

2-9. Parking Permit

Students are not allowed to commute to the university by car. In cases of injury or sickness, or for deliveries, a temporary parking permit can be issued by submitting a form to the SDM Office five days prior to the day of use.

2-10. Cafeteria

Students may use the school cafeteria on weekdays to hold receptions and parties for school clubs, with faculty members, with alumni, etc. First, make a reservation at the school cafeteria and then submit the “Request to Hold Meeting/Gathering on Campus” (学内集会届) to the Hiyoshi Office of Student Services located on the first floor of the Independence Wing (Fourth Building) within two weeks of making the reservation. Please note that the reservation may be cancelled if a student fails to submit this form.

2-11. Filming and Taking Photographs on Campus

To film or take photographs on Hiyoshi Campus, please submit an “Application for Permission to Film/Photograph on Campus” (構内撮影許可申請) to the Hiyoshi Office of Student Services. For details, ask at the SDM Office.

2-12. Posters and Pamphlets

Apply for permission at the SDM Office to put up posters and distribute pamphlets on campus.

3. Certificates (Master's/ Doctoral)

Current students can obtain certificates at:

- Certificate issuing machines on each campus
- Convenience stores nationwide (Family Mart, Lawson, Seven-Eleven [listed in alphabetical order]) *except for Gakuwari

For further information regarding the service, see the website below:

<https://www.students.keio.ac.jp/en/com/procedure/certificate/issue.html>

Please check the schedule for the operating hours of the Certificate Issuing Machines. The machines may be unavailable due to maintenance or for other reasons.

3-1. Certificate of Expected Completion

The Certificate of Expected Completion can be issued in the third semester of the master's program (excluding temporary leaves of absence).

If certificates in English or sealed certificates are necessary, apply at the SDM Office. Any certificates already issued by the Certificate Issuing Machines and Convenience stores cannot be sealed.

3-2. Certificate of Annual Health Examination

The Certificate of Annual Health Examination is issued for students who took the health check. Please be aware that this certificate is only issued to students who have taken the annual health check. For more information, please see the Health Center website (<http://www.hcc.keio.ac.jp/en/index.html>).

3-3. Student Travel Fare Discount Certificate (Gakuwari)

*Not available at convenience stores

When traveling over 100 kilometers, a Student Travel Fare Discount Certificate may be used. A student may issue up to ten certificates per day. Certificates are valid for three months from the day of issuance. Be sure to give yourself plenty of time when applying for certificates just before holidays. Please note that this certificate cannot be issued if a student has not taken the annual health check.

4. Scholarships (Master's/ Doctoral)

Applying for Scholarships

International students who wish to apply for scholarships through Keio University must hold a residence status of “Student.” Additionally, international students must submit the “Scholarship Application Registration Form” (奨学金受給希望調査書) with their academic transcript and other necessary documents by the deadline each semester. Please refer to the following website for application procedures.

<http://www.ic.keio.ac.jp/en/life/scholarship/application.html> (English)

http://www.ic.keio.ac.jp/intl_student/scholarship/keio_student.html (Japanese)

For an overview of scholarships for international students, refer to the following website.

http://www.ic.keio.ac.jp/en/life/scholarship/intl_student.html (English)

http://www.ic.keio.ac.jp/intl_student/scholarship/intl_student.html (Japanese)

5. Annual Health Check, Student Health Insurance, Counseling, and Career Support (Master's/ Doctoral)

5-1. Annual Health Check

In accordance with the School Health and Safety Act and the Graduate School Rules, an annual health check is provided to students every spring to promote their health and to prevent, detect, and treat disease in the early stages. If you take a checkup at a hospital or clinic outside Keio University, the report of the health check must be submitted to the Health Center on Hiyoshi Campus.

If any disease or other medical condition is found, the student will be notified directly along with information on the appropriate measures to be taken.

In order to promote the students' health, a complete examination is provided at the University Health Center, which includes issuance of introduction letters to Keio University Hospital for reexaminations, and treatments and regular consultations at the Health Center.

Please note that the Certificate of Annual Health Examination and the Student Travel Fare Discount Certificate will not be issued to students who do not take the annual health check.

Regarding treatments at the University Health Center, half of the fee is paid for by students and the other half is covered by the Keio Student Health Care Mutual Aid Association (Gakuseikenpo). Students must immediately notify the SDM Office (045-564-2518) or the security office (045-564-2452 extension: 37100) after office hours and holidays if they are involved in an accident on campus. Appropriate measures will be taken immediately to call an ambulance or contact medical institutions.

5-2. Notification of Infectious Disease

Under the School Health and Safety Act, if students are found to be infected or are potentially infected with communicable diseases (including COVID-19, in addition to influenza, rubella, measles, etc.) they are prohibited from attending classes (coming to the university). For more details, please visit the Health Center website (<http://www.hcc.keio.ac.jp/en/index.html>). In addition, to prevent widespread infection of influenza, rubella or measles, we advise you to talk to your doctor and arrange the appropriate vaccinations.

A "Permission of Return to Campus After Illness" (感染症登校許可証明書) form must be submitted when coming back to university. The form may be obtained from the website below. You must ask your doctor to fill it out. Submit the form to the Hiyoshi Health Center and have an interview with a doctor residing at the Health Center. This interview is mandatory.

If you had influenza, on the first day of returning to university, please fill out the part inside the bold lines and then submit this form and a document showing that you had influenza (e.g., explanation of your prescription, the envelope that contained the medicine) to the Health Center.

Health Center website: <http://www.hcc.keio.ac.jp/en/index.html>

Reference: period for suspension of university attendance

- Measles: three days after your temperature begins to recede
- Rubella: until the rash disappears

- Chicken pox: until the rash over the body disappears
- Mumps: until the parotid swelling subsides
- Influenza: two days after your temperature begins to recede

5-3. Keio Student Health Care Mutual Aid Association (Gakuseikenpo)

Full-time students at Keio University are members of the Keio Student Health Care Mutual Aid Association (Gakuseikenpo; 学生健康保険互助組合). When you receive medical treatment by indicating your insurance card, the Keio Student Health Care Mutual Aid Association will transfer the reimbursement amount for your treatment to your bank account. For more detailed information, please refer to the handbook. The handbook is available at the Keio University Student website. URL: <https://www.students.keio.ac.jp/en/com/life/health/>

5-4. Personal Accident Insurance for Students Pursuing Education and Research with the Additional Coverage for Commuting Accidents

Keio University is a member of Japan Educational Exchange and Service, which offers the “Personal Accident Insurance for Students Pursuing Education and Research” (学生教育研究災害傷害保険) **with the "Additional Coverage for Commuting Accidents”** (通学中等傷害危険担保特約). This insurance plan covers against unexpected accidents during the course of your educational and research activities and commuting to school.

Activities covered by this insurance:

- Academic and extracurricular activities or events on and off campus.
- For off-campus activities, please submit a Notification of Off-campus Student Activities to the SDM Office four days before the activity.

5-5. Optional Compensation

There are three types of optional compensation: “insurance” and “mutual aid.” Students should apply for these directly if they wish to be covered.

Insurance for accidents involving third parties or their property: Japan Educational Exchange and Service (You can apply at the Office of Student Services.)

Student Comprehensive Insurance: Keio Academic Enterprises (Tel: 03-3453-3846)

Student Comprehensive Mutual Insurance and Personal Liability Insurance for Students: Keio Co-op (Tel: 045-563-8489)

5-6. Student Counseling Room <https://www.students.keio.ac.jp/en/com/life/consult/counseling-room.html>

The Student Counseling Room is open to all students on an advance reservation basis. University regulations ensure a strict privacy policy. Students are always welcome with their family and friends. Introduction to other departments and organizations will be made if necessary. Students are encouraged to attend various group meetings that are held to enrich their campus experience. For further information, please visit their webpage.

5-7. Keio University Harassment Prevention Committee

If you believe that you are being harassed, don't feel that you should blame yourself or tolerate it. Contact the Harassment Prevention Committee Consultation Office. For further information, please visit the following website: <http://www.harass-pco.keio.ac.jp/en/index.html>

5-8. Lost and Found

The Office of Student Services holds onto lost and found items for three months. For items lost or found in the Collaboration Complex, inquire at the Security Center located on the first floor of the Collaboration Complex.

5-9. Placement and Career Services

Career support is provided to promote opportunities for employment.

A. Guidance and seminars

- Job seminars by external instructors
- Guidance and seminars at other campuses (available to students)

B. Information on employment offers, company information, list of Keio alumni, and internship information

Information on employment offers, seminars, and student job search notifications are available on keio.jp. For more information, please visit the website. In addition, information sent from companies is available to browse at the SDM Office.

C. Interview training and job application form corrections

Together with Arcturus, a human resource development and recruiting company, SDM offers career support services such as individual interview training, job application form corrections, and seminars for job seekers. Details are announced in the “For Students” section of the SDM home page (<http://www.sdm.keio.ac.jp/en/student/>).

D. Employment report

All students are required to complete a survey titled “Plans After Graduation” (進路届; for example, work full-time or go on to a Ph.D. program). The information will be used by Keio University to help future students with their job search, as well as for statistics and surveys by external institution.

Your place of employment (if any) after graduating SDM may be listed on the SDM website and brochures (your name will not be disclosed).

Details are announced in the “For Students” section of the SDM home page (<http://www.sdm.keio.ac.jp/en/student/>).

5-10. Access to the Networks

In order to use the computers and printers located at the Information Technology Center (ITC) on Hiyoshi, Mita, Yagami, and Shinanomachi Campuses, an ITC account is necessary. Students are required to follow ITC regulations when using the network system.

A SDM wireless network (sdm-mobile2) is available inside the Collaboration Complex. A printer is available in room C3N15.

6. Curriculum and Process for Degree Completion (Master's Program)

6-1. Courses

The courses for the master's program are listed below. Depending on the course, extra hours may be required for seminars, assignments, and class preparation. There is no limit on the number of courses for which a student may register. However, students should consult with the lecturer and their research advisors to ensure that they register for an appropriate number of courses.

The numbers in the brackets specify the credits awarded for the course.

Required Subjects

Core Subject	Project Subject
INTRODUCTION TO SYSTEM DESIGN AND MANAGEMENT (J) (2)	DESIGN PROJECT (JE) (4)
INTRODUCTION TO SYSTEM DESIGN AND MANAGEMENT (E) (2)	
SYSTEM ARCHITECTING AND INTEGRATION (J) (2)	Special Research Subjects *1
SYSTEM ARCHITECTING AND INTEGRATION (E) (2)	RESEARCH ON SYSTEM DESIGN AND MANAGEMENT (2)
SYSTEM VERIFICATION AND VALIDATION (J) (2)	RESEARCH ON PROJECT DESIGN AND MANAGEMENT (2)
SYSTEM VERIFICATION AND VALIDATION (E) (2)	
PROJECT MANAGEMENT (J) (2)	
PROJECT MANAGEMENT (E) (2)	

SDM RESEARCH METHODOLOGY (J) *2

SDM RESEARCH METHODOLOGY (E) *2

Major Subjects

Recommended Basic Subjects	
COMMUNICATIONS (E) (2)	STATISTICS AND DATA PROCESSING FOR SYSTEM DESIGN (J) (2)
PROJECT MANAGEMENT FUNDAMENTALS (J) (2)	
Recommended Advanced Subjects	
SYSTEMS APPROACH FOR SOCIAL SYSTEMS (J) (2)	COMPETENCY AND SKILL-BUILDING (J) (2)
MODELING AND SIMULATION OF SYSTEMS (J) (2)	WORKSHOP DESIGN METHODOLOGY FOR INNOVATION1 (J) (1)
SPECIAL LECTURES 1 (J) (2) (Offered in odd-numbered years)	WORKSHOP DESIGN METHODOLOGY FOR INNOVATION2 (J) (1)
SPECIAL LECTURES 2 (J) (2) (Offered in even-numbered years)	
Major Subjects in Systems and Socio-Tech Engineering	
PRACTICE OF SYSTEM DESIGN AND MANAGEMENT (J) (2)	BASIC THEORY AND PRACTICE OF ARTIFICIAL INTELLIGENCE (J) (2)
PRACTICE OF SYSTEM DESIGN AND MANAGEMENT (E) (2) (Offered in even-numbered years)	SOFTWARE DESIGN PROCESS (J) (2)
FRONTIER PROJECT MANAGEMENT (JE) (2)	DESIGN SCIENCE AND PROJECT (J) (2) *3
FOUNDATION OF MODEL-BASED SYSTEMS ENGINEERING (E) (2)	SPACE SYSTEMS ENGINEERING (J) (2) *3
FOUNDATION OF MODEL-BASED SYSTEMS ENGINEERING (J) (2)	SPATIAL USER INTERFACE (J) (2) *3
ARCHITECTURE FOR DIGITAL TRANSFORMATION (EJ) (2)	NETWORK AND DATABASE SYSTEMS (J) (2) (Offered in odd-numbered years)
MODEL-BASED CONCEPTUAL DESIGN AND MANAGEMENT (E) (2)	
Major Subjects in Safe, Reliable, Human, Symbiotic & Innovation Systems	
MINDFULNESS-BASED STRATEGIC AWARENESS TRAINING (EJ) (2)	WELL-BEING MANAGEMENT (J) (2) (Offered in odd-numbered years)
HUMAN RELATIONS (J) (2)	ANALYTICAL METHODS FOR HUMANITIES AND SOCIAL SCIENCES (J) (2)
HUMAN INTERFACE (J) (2)	SUSTAINABLE URBAN SYSTEMS 1 (J) (2)
VIRTUAL DESIGN (EJ) (2)	SUSTAINABLE URBAN SYSTEMS 2 (JE) (2)
SYSTEM ASSURANCE (J) (2)	STUDIOS FOR URBAN SYSTEMS DESIGN (JE) (2)
INNOVATIVE DESIGN METHODOLOGY (J) (2) (Offered in even-numbered years)	LEADERSHIP DEVELOPMENT THROUGH CREATIVE EXPRESSION AND ROLE-PLAY (EJ) (2)
Major Subjects in Political, Economic and Business Systems	
INTERNATIONAL POLITICAL ECONOMY: DISCUSSIONS ON ITS SYSTEMS (J) (2)	PROGRAM MANAGEMENT (J) (2)
INTERNATIONAL POLITICAL ECONOMY: DISCUSSIONS ON ITS SYSTEMS (E) (2)	PROGRAM MANAGEMENT (E) (2)
DEVELOPMENT OF JAPAN'S POLITICO-ECONOMIC SYSTEMS (E) (2)	INTERNSHIP1 (J) (1) *4
POLITICAL SYSTEM (EJ) (2) (Offered in even-numbered years)	INTERNSHIP2 (J) (2) *4
BUSINESS PROCESS MODELING AND MANAGEMENT (J) (2)	TECHNICAL ENTREPRENEURSHIP (E) (2)
ENTREPRENEURSHIP DESIGN THEORY (J) (2) (Offered in odd-numbered years)	SERVICE ENGINEERING (J) (2)
SOCIAL SURVEY METHODS (J) (2)	THE MECHANISM OF ACCOUNTING SYSTEM IN THE CONTEXT OF ECONOMIC SYSTEM DESIGN (EJ) (2)

Notes:

<Table of corresponding courses >

•The meanings of (J), (E), (JE), (EJ) are as follows:

(J): Course is offered in Japanese

(E): Course is offered in English

(JE): Lectures are in Japanese with English materials and brief commentary

(EJ): Lectures are in English with Japanese commentary

*1. The “Special Research Subjects” do not have timetabled classes. Credits are awarded for the research of the master’s students. “Research on System Design and Management” is for students enrolled in the Research-Intensive Course. “Research on Project Design and Management” is for students enrolled in the Learning-Intensive Course.

*2. “SDM RESEARCH METHODOLOGY” is a course related to “RESEARCH ON SYSTEM DESIGN AND MANAGEMENT” that is for RI and LI students in the third semester.

*3. “Spatial User Interface,” “Space Systems Engineering,” and “Design Science and Project” are courses jointly held with the Graduate School of Science and Technology. These courses are mainly held at the Yagami Campus. The syllabi for these courses are not available on the SDM e-learning System and must be accessed from the Graduate School of Science and Technology website (<https://gslbs.adst.keio.ac.jp/index.html>).

*The SDM course “Design Science and Project” is registered only as “Design Project” at the Graduate School of Science and Technology. Students will need to search for “Design Project” to find the course syllabus.

*The grading for these courses is based on the criteria set by the Graduate School of Science and Technology. Inquire at the SDM office for further details.

*4. The “Internship 1” and “Internship 2” courses were set up so that students could learn of the relationship between their studies and business practices, improve their professional awareness, and to accurately grasp their respective aptitudes through practical experience only possible outside of the university curriculum. Students participate in internship programs at companies and external research institutions during vacations periods such as the summer break, and credits are later awarded to students who satisfactorily complete a report of their activities in accordance with the number of hours undertaken.

Course name	Field in Major Courses	Number of credits	Hours of participation
INTERNSHIP 1	Political, Economic and Business Systems	1	120 hours
INTERNSHIP 2	Political, Economic and Business Systems	2	240 hours

[Choosing an internship program]

Students wishing to do an internship should search for opportunities using the internship listings on job websites and the SDM website respectively.

In principle, students are not permitted to miss classes in order to participate in internships. However, as certain classes may employ alternative teaching methods such as e-learning, students should consult with the faculty members in charge of the courses concerned. Students should also consult in advance with the faculty member overseeing the internship, as it may not be possible to earn credits depending on the program content.

[Pre-internship]

- Documents for submission to company (excluding the IBM internship program)
 - Notify the SDM office of the names of the host organization and contact person. The SDM office will issue you with a “Certificate of Internship Participation (Form 1)” (インターンシップ参加証明書(様式1)) and a Letter of Request.
- Insurance for Internships (all students wanting to do an internship)
 - Students should join the “Liability Insurance for Internships, Professional Qualification Activities, etc. (INTERN-L)” to protect themselves against all eventualities, including accidental damage to equipment or injury to persons at the host organization. Students can join for a premium of 210 yen at the SDM Office.
- “Application for Permission to Engage in Activity other than that Permitted under the Status of Residence Previously Granted” (資格外活動許可申請書; for international students only)
 - International students intending to engage in activities yielding remuneration not permitted under their current status of residence must apply for the appropriate permit. Application forms are available at the SDM Office. It takes approximately two weeks to obtain a permit. Students should prepare well in advance and ensure they obtain permission before starting the internship.

[Mid-internship]

- Submit the Letter of Request and the Certificate of Internship Participation (Form1) to the person in charge at the host organization and ask for the latter to be filled out and returned upon conclusion of the program. The host organization may use its own format for the certificate of participation.

[Post-internship]

- Submit a report and an “Application for Credits for Internship 1 & 2 (Form 2)” (インターンシップ1・2認定願(様式2))
 - Submit the following documents to the SDM Office:
 - a. Application for Credits for Internship 1 & 2 (Form 2)
 - Download from <http://www.sdm.keio.ac.jp/student/career/internship.html> (Japanese language only)
 - b. Report
 - Students should write a report of about three-pages on A4 detailing their achievements during the internship (no prescribed format). Do not include any confidential information.
 - c. Outline of the internship (application guidelines, etc.)
 - d. Completed “Certificate of Internship Participation (Form 1)” (インターンシップ参加証明書(様式1))
- Interview with the faculty member in charge of the internship course
 - Students should request to attend an interview with the faculty member overseeing the internship. After the interview, students must collect a completed Application for Credits for Internship 1 & 2 (Form 2), which the SDM Office will provide the faculty member in charge in advance.

[Course registration]

- Students must bring the completed Application for Credits for Internship 1 & 2 (Form 2) to the SDM Office to register the course.

[Grades for internship and notification]

The faculty member in charge of the internship course will determine whether to award credits based on the interview and report. If approved, a grade of [PASS] will be awarded for this course together with the grades of the other courses the student has taken at the end of the semester.

6-2. Requirements for Completion of Degree

A. Degrees Awarded by SDM

<Research-Intensive Course>

Master's Degree (System Engineering)

Master's Degree (System Design and Management)

<Learning-Intensive Course>

Master's Degree (System Design and Management)

B. Requirements for Degree Completion

<Research-Intensive Course>

1. Be enrolled at SDM for four or more semesters, excluding temporary leaves of absence. Cases of early completion of the degree upon fulfillment of the program requirements will be determined separately.
2. Earn credits in accordance with the requirements set forth in Article 108 Section 33-2 of the Graduate School Rules.
3. Pass the master's thesis and final examinations.

(Excerpt from the Graduate School Rules)

Article 108 Section 33-2

1. To fulfill the requirements for a master's degree in the Research-Intensive Course, a student must earn at least 36 credits through courses and satisfy the requirements specified in the following section and Article 109.
2. A student must satisfy the credit requirements in each of the following items in order to be awarded a master's degree.

1. Required Courses

- Core Subjects: 8 credits
- Special Research Subjects: 8 credits
- Project Subjects: 4 credits

2. Major Courses: At least 16 credits

3. Notwithstanding the provisions of the preceding paragraph, separate provisions shall be made for cases of early degree completion.

* Credits for master's thesis research will be awarded as credits for the Special Research Subject, "RESEARCH ON SYSTEM DESIGN AND MANAGEMENT."

<Learning-Intensive Course>

1. Be enrolled at SDM for four or more semesters, excluding temporary leaves of absence. Cases of early completion of the degree upon fulfillment of the program requirements will be determined separately.
2. Earn credits in accordance with the requirements set forth in Article 108 Section 33-3 of the Graduate School Rules.
3. Pass the master's thesis and final examinations.

(Excerpt from the Graduate School Rules)

Article 108 Section 33-3

1. To fulfill the requirements for a master's degree in the Learning-Intensive Course, a student must earn at least 46 credits through courses and satisfy the requirements specified in the following section and Article 109.
2. A student must satisfy the credit requirements in each of the following items in order to be awarded a master's degree.

1. Required Courses

- Core Subjects: 8 credits
- Special Research Subjects: 2 credits
(Research on Project Design and Management)
- Project Subjects: 4 credits

2. Major Courses: At least 32 credits

3. Notwithstanding the provisions of the preceding paragraph, separate provisions shall be made for cases of early degree completion.

* Credits for master's thesis research will be awarded as credits for the Special Research Subject, "RESEARCH ON PROJECT DESIGN AND MANAGEMENT".

<Maximum Number of Credits that can be Earned through E-learning Courses>

If you are unable to attend every class but have a strong desire to take the course, you may register for the e-learning course.

You can view lectures and earn credits by submitting assignments through the e-learning system. The class lecture videos are uploaded roughly once a week after the class is given.

The maximum number of credits that can be earned through e-learning is:

Research-Intensive Course: 10 credits

Learning-Intensive Course: 30 credits (20 credits for students who enrolled in or before 2018)

Refer to "6-3-4. F. Notes for Registering e-learning Courses" for details.

<Changing Course>

For first year master's students enrolled in/after Academic Year 2019, application for change of course may be approved after being screened by the research advisors and the Graduate School of System Design and Management Committee. Contact the SDM Office for more information.

1. Credits after Changing Course

a. Change Research-Intensive Course to Learning-Intensive Course:

The 2 or 4 credits that are earned for Special Research Subjects in semesters 1 and 2 will be awarded as credits for Optional Subjects.

b. Change Learning-Intensive Course to Research-Intensive Course:

When changing the course of study, the credits which needed to be obtained by this time for Special Research Subjects will be awarded. *The maximum number of e-learning courses that can be taken is different for the Learning Intensive Course and Research Intensive Course. If changing the course of study, the maximum number of credits permitted by

the Research Intensive Course, which has a lower credit limit than the Learning Intensive Course, can be carried over. All other credits earned through e-learning will be awarded as credits for Optional Subjects.

* Refer to "Maximum Number of Credits that can be earned through E-learning Courses" above.

2. Points to Note

It is not approved to change Research-Intensive Course to Learning-Intensive Course if you get a D grade for any of Special Research Subjects in the first two semesters.

C. Process for Completing Degree

1. Schedule

<Students enrolled in the Research-Intensive Course>

<First year>

Enrollment	Apr. 2020	Sept. 2020	Apr. 2021	Sept. 2021
Orientation	Apr. 3, 2020	Online orientation	Online orientation	Online orientation
Course registration	Apr. 16-21, 2020	Sept.25-28, 2020	①Apr. 3-5, 2021 ②Apr. 6-14, 2021	①Sep. 27-29, 2021 ②Sep. 30-Oct.8, 2021
Submission of form on preferred research supervisor	May. 25, 2020	Sept. 28, 2020	Apr. 12, 2021	Sept. 27, 2021
Decision of research supervisor	Jun. 12, 2020	Oct.6 2020	Apr. 22, 2021	Oct. 5, 2021
Theme Presentations (deadline for prior submission of presentation manuscript: 23:59 on the day before presentations)	Sept. 12, 2020	Jan.30, 2021	Sept. 11, 2021	Jan. 29, 2022
Course registration	Sept.25-28, 2020	①Apr. 3-5, 2021 ②Apr. 6-14, 2021	①Sep. 27-29, 2021 ②Sep. 30-Oct.8, 2021	Early Apr., 2022
First interim presentation (deadline for prior submission of presentation abstract (résumé) and manuscript: 23:59 on the day before presentations)	Feb. 13 2021	Sept. 18, 2021	Feb. 12, 2022	Mid-Sept., 2022
Approval to commence master's thesis	Mid-Mar., 2021	Mid-Sept., 2021	Mid-Mar., 2022	Mid-Sept., 2022

<Second year>

Course registration	①Apr.3-5,2021 ②Apr.6-14, 2021	①Sep. 27-29, 2021 ②Sep. 30-Oct.8, 2021	Early Apr. 2022	Late Sept., 2022
Second interim presentation (deadline for prior submission of presentation abstract (résumé) and manuscript: 23:59 on the day before presentations)	Sept. 18, 2021	Feb. 12, 2022	Mid- Sept. 2022	Mid-Feb., 2023
Course registration	①Sep. 27-29, 2021 ②Sep. 30-Oct.8, 2021	Early Apr., 2022	Late Sept., 2022	Early Apr., 2023
Secondary advisor assigned	Nov.12, 2021	Early June, 2022	Mid-Nov., 2022	Early June, 2023

Submission of applications for tentative title of master's thesis and degree, and materials formatted for publication	Nov. 30, 2021	Mid-June, 2022	Early Dec., 2022	Mid-June, 2023
Registration of thesis title and submission of master's thesis, "Primary and Secondary Advisors Check Sheet", and "Master's Thesis Consent Form"	Jan. 21, 2022	Mid-July, 2022	Late Jan., 2023	Mid-July, 2023
Examination of master's thesis (deadline for prior submission of presentation manuscript: 23:59 on the day before presentations) *If the presentations are held over a two-day period, submit the day before the first round of presentations.	Jan. 28-29, 2022	Early Aug., 2022	Early Feb., 2023	Late July, 2023
Re-examination of master's thesis (applicable students only)	Feb. 10, 2022	Mid-Aug., 2022	Mid-Feb., 2023	Mid-Aug., 2023
Submission of the final draft of the master's thesis, materials formatted for publication, and application form	Feb. 11, 2022	Mid-Aug., 2022	Mid-Feb., 2023	Mid-Aug., 2023
Announcement of students who have completed the master's program	Mar. 10, 2022	Early Sept., 2022	Early Mar., 2023	Early Sept., 2023
Commencement ceremony	Mar. 28, 2022	Mid-Sept., 2022	Late Mar., 2023	Mid-Sept., 2023

*The above schedules are subject to change.

<Students enrolled in the Learning-Intensive Course>

Learning-Intensive Course students can register for the Special Research Subjects **in the last semester of second year only.**

<First year>

Enrollment	Apr. 2020	Sept. 2020	Apr. 2021	Sept. 2021
Orientation	Apr. 3, 2020	Online orientation	Online orientation	Online orientation
Course registration	Apr. 16-21, 2020	Sept.25-28, 2020	①Apr. 3-5, 2021 ②Apr. 6-14, 2021	①Sep. 27-29, 2021 ②Sep. 30-Oct.8, 2021
Submission of form on preferred research supervisor	May. 25, 2020	Sept. 28, 2020	Apr. 12, 2021	Sept. 27, 2021
Decision of research supervisors	Jun. 12, 2020	Oct.6 2020	Apr. 22, 2021	Oct. 5, 2021
Course registration	Sept.25-28, 2020	①Apr. 3-5, 2021 ②Apr. 6-14, 2021	①Sep. 27-29, 2021 ②Sep. 30-Oct.8, 2021	Early Apr., 2022
Approval to commence master's thesis	Mid-Mar., 2021	Mid-Sept., 2021	Mid-Mar., 2022	Mid-Sept., 2022

<Second year>

Course registration	①Apr. 3-5, 2021 ②Apr. 6-14, 2021	①Sep.27-29, 2021 ②Sep.30-Oct.8, 2021	Mid- April, 2022	Late Sept., 2022
---------------------	-------------------------------------	---	------------------	------------------

Theme Presentations (deadline for prior submission of presentation manuscript: 23:59 on the day before presentations)	Sept. 11, 2021	Feb. 12, 2022	Mid-Sept., 2022	Late Jan., 2023
Course registration	①Sep. 27-29, 2021 ②Sep. 30-Oct. 8, 2021	Early Apr., 2022	Late Sept., 2022	Early Apr., 2023
Secondary advisor assigned	Mid-Nov., 2021	Early June, 2022	Mid-Nov., 2022	Early June, 2023
Submission of applications for tentative title of master's thesis and degree	Nov. 30, 2021	Mid-June, 2022	Early Dec., 2022	Mid-June, 2023
Registration of thesis title and submission of master's thesis, "Primary and Secondary Advisors Check Sheet," and "Master's Thesis Consent Form"	Jan. 21, 2022	Mid-July, 2022	Late Jan., 2023	Mid-July, 2023
Examination of master's thesis (deadline for prior submission of presentation manuscript: 23:59 on the day before presentations) *If the presentations are held over a two-day period, submit the day before the first round of presentations.	Jan. 28-29, 2022	Early Aug., 2022	Early Feb., 2023	Late July, 2023
Re-examination of master's thesis (applicable students only)	Feb. 10, 2022	Mid-Aug., 2022	Mid-Feb., 2023	Mid-Aug., 2023
Submission of final draft of master's thesis and application form	Feb. 11, 2022	Mid-Aug., 2022	Mid-Feb., 2023	Mid-Aug., 2023
Announcement of students who have completed the master's program	Mar. 10, 2022	Early Sept., 2022	Early Mar., 2023	Early Sept., 2023
Commencement ceremony	Mar. 28, 2022	Mid-Sept., 2022	Late Mar., 2023	Mid-Sept., 2023

*The above schedules are subject to change.

2. Theme presentation, etc.,

- **Theme presentations** *Details to be announced by the SDM Office.

[Presentation time]

<**Research-Intensive Course**> Total of 6 minutes per student (3 minutes to present and 3 minutes for Q&A).

<**Learning-Intensive Course**> Total of 12 minutes per student (7 minutes to present and 5 minutes for Q&A).

[Advance submissions] Presentation slides (PPT file).

[How to submit] Upload to the e-learning system. *The URL and additional information will be provided by the SDM Office.

[Submission deadline] In principle, by 23:59 on the day prior to the presentation. *The precise dates and times will be provided by the SDM Office.

[Grading criteria]

<**Research-Intensive Course**>

- Is the student tackling a topic that is suitable for a research project at SDM?
- Grasp of background and existing research: Does the student have a grasp of the existing research and theories

surrounding the topic or issue?

c. Presentation skills: Has the student successfully conveyed the content of the research to the listeners within the allotted time?

<Learning-Intensive Course>

a. Problem awareness: Willingness to tackle difficult problems and issues previously overlooked.

Has the issue under consideration been clearly identified? Has the student clarified why and how he or she wishes to tackle this particular issue? Does the student have a clear idea of what he or she wishes to contribute to his or her field through this research?

b. Research scope: Has the student been able to narrow down the problem, specify a suitable question, and set the scope of research within practical and reasonable bounds?

c. Grasp of basic knowledge and existing research: Does the student have a grasp of the existing research and theories (both academically and more generally) on the research topic?

Does the student have a grasp of the overall background and the arguments presented in the existing research in his or her chosen topic?

d. Approach of research and progress: Does the student have a feasible plan for completing his or her research objectives? Has the methodology, means of implementation, and plan of action been adequately deliberated?

e. Presentation skills: Has the student been able to successfully convey to listeners the above four points within the allotted time?

[Important notes] (Theme presentations)

* The theme presentations may be conducted in either Japanese or English.

*The presentation material and abstract must be checked by the research advisor prior to the presentation.

*All students must attend the presentations of other students in one of the two rooms hosting the event.

*On the day of the presentations, a PC with the presentation files of all students in each room must be prepared to ensure that the event proceeds smoothly.

*The SDM Office will announce the order of the presentations.

- **Interim presentations** *Details to be announced by the SDM Office.

[Presentation time]

First interim presentation: Total of 10 minutes per student (7 minutes to present and 3 minutes for Q&A).

Second interim presentation: Total of 15 minutes per student (7 minutes to present and 8 minutes for Q&A).

[Advance submissions] Presentation abstract (résumé) and slides (PPT file).

[How to submit] Upload to the e-learning system. *The URL and additional information will be provided by the SDM Office.

[Submission deadlines] In principle, by 23:59 on the day prior to the presentation. *The precise dates and times will be provided by the SDM Office.

[Grading criteria]

a. Overview of research:

Is the research on an important and challenging real-world problem?

Does the student know the key research literature on the issue under consideration?

Is the student aware of the current circumstances and effectiveness of any solutions previously proposed regarding this issue?

Does the student have an overall command of related issues and an understanding of the position and significance of his or her own research within the broader research agenda?

b. Originality and creativity:

Does the research question, methodology, and hypothesis demonstrate originality and creativity?

Does the student's approach to and engagement with the research question demonstrate originality or creativity?

Has the student collected and analyzed new facts and data?

c. Research question and hypothesis:

Has the research question been framed appropriately? Has the student been consistent in the formulation and development of his or her hypothesis?

Is the research question realistic and suitable for the research topic, and is the hypothesis logically coherent? Is the field of investigation appropriate for the research question?

d. Quality of research proposal and development:

Is the proposed policy solution realistic and within the bounds of real-world constraints?

Are the research conclusions realistic in terms of effectiveness and adoptability?

e. Quality of presentation:

Would the presentation be persuasive and comprehensible to the layperson?

Is the structure of the presentation easily understandable?

Does the proposed solution follow the basic framework of SDM?

[Important notes] (Interim presentations)

*The interim presentations may be conducted in either Japanese or English.

*The presentation material and abstract must be checked by the research advisor prior to the presentation.

*All students must attend the presentations of other students in one of the two rooms hosting the event.

*On the day of the presentations, a PC with the presentation files of all students in each room must be prepared to ensure that the event proceeds smoothly.

*The SDM Office will announce the order of the presentations.

• **Submission of the master's thesis *Details to be announced by the SDM Office.**

[Submission deadline] Approximately one week before the examination of the master's thesis. The submission deadlines are strictly enforced and late submissions will not be accepted. Furthermore, updates and revisions to submitted files are not permitted after the deadline. *The SDM Office will contact students making a submission on an individual basis regarding the schedule.

[How to submit] Upload the thesis to the e-learning system as a PDF/A file. The e-learning system does not accept any formats other than PDF, including Word files. *The URL and additional information will be provided by the SDM Office.

[Structure of thesis] The thesis is to be comprised of a cover page, an abstract in English and Japanese (one page each), and the main text (no prescribed format). All parts of the thesis must be submitted as a single PDF file.

• **Submission of the "Master's Thesis Consent Form" (論文利用許諾書)**

[Submission deadline] Same as that for the final draft of the master's thesis.

*The SDM Office will contact students regarding the details.

[How to submit] To be submitted to the student's research advisor.

*Visit the "Master's degree information" page under "For Students" on the SDM home page for the forms, etc.
<http://www.sdm.keio.ac.jp/en/student/master/thesis.html>

Theses written in English are to be comprised of a cover page, an English abstract (one page), and the main text.

Students should consult with their research advisor regarding the format of the main text.

Submissions in color are permitted, but students must ensure that the thesis is legible when printed in monochrome.

• **Examination of master's thesis *Details to be announced by the SDM Office.**

[Presentation time]

<**Research-Intensive Course**> Total of 30 minutes per student (15 minutes to present and 15 minutes for Q&A).

<**Learning-Intensive Course**> Total of 20 minutes per student (10 minutes to present and 10 minutes for Q&A).

[Advance submissions] Presentation slides (PPT file). *Students must consult with their research advisor for further details.

[How to submit] Upload to the e-learning system.

[Submission deadline] In principle, by 23:59 on the day prior to the presentation.

[Materials required on day of presentation] Bring two copies of the master thesis in A4 flat file binders to the examination venue for perusal by the examiners.

[Important notes] To shorten the time between presentations, students are required to save their presentation materials on the PC in the examination venue and should confirm that PowerPoint files, videos, and any other software required function correctly beforehand. The scheduling for the presentations is strictly enforced and any time used to resolve computer-related issues or for the changeover of presenters will count toward the time allocated for the presentation.

[Grading criteria]

<**Research-Intensive Course**>

a. Overview of research:

Is the research on a substantially important and challenging real-world problem?

Does the student know the key research literature on the issue under consideration?

Is the student aware of the current circumstances and effectiveness of any solutions previously proposed regarding this issue?

Does the student have an overall command of related issues and an understanding of the position and significance of his or her own research within the broader research agenda?

b. Originality/creativity:

Originality and creativity:

Does the research question, methodology, and hypothesis demonstrate originality and creativity?

Does the student's approach to and engagement with the research question demonstrate originality or creativity?

Has the student collected and analyzed new facts and data?

c. Research question and hypothesis:

Has the research question been framed appropriately? Has the student been consistent in the formulation and

development of his or her hypothesis? Is the research question suitable for the research topic, and is the hypothesis logically coherent? Is the field of investigation appropriate for the research question?

d. Clarity of conclusion and quality of investigation:

Are the research results valid, reproducible, and clear in terms of scope and applicability?

Has the student adequately identified the achievements of this research and areas requiring further investigation?

Has an adequate investigation been conducted and does it support the conclusions reached? Are the results of the research effective and practically applicable?

e. Quality of presentation:

Would the presentation be persuasive and comprehensible to the layperson?

Is the structure of the presentation easily understandable?

Does the proposed solution follow the basic framework of SDM?

Has the thesis been completed?

<Learning-Intensive Course>

a. Overview of research:

Does the student know the key research literature on the issue under consideration?

Has the student clearly set forth the structure of the thesis irrespective of the complexities of the issue under consideration?

Is the student aware of the current circumstances and effectiveness of any solutions previously proposed regarding this issue?

Does the student have an overall command of related issues and an understanding of the position and significance of his or her own research within the broader research agenda?

b. Effectiveness and applicability of results:

Is the research question relevant for real-world solutions?

Is the student's approach to and engagement with the research question logically consistent and clearly explained?

Has the student collected and analyzed data that is realistic and practical?

c. Research question and hypothesis:

Has the research question been framed appropriately? Has the formation and development of the hypothesis been consistent or does the student demonstrate a willingness to tackle difficult issues? Is the research question suitable for the research topic, and is the hypothesis logically coherent? Is the field of investigation appropriate for the research question?

d. Clarity of conclusion and quality of investigation:

Are the research results valid, reproducible, and clear in terms of scope and applicability?

Has an adequate investigation been conducted and does it support the conclusions reached? Are the results of the research effective and practically applicable?

e. Quality of presentation and perfection of thesis:

Would the presentation be persuasive and comprehensible to the layperson?

Is the structure of the presentation easily understandable?

Does the proposed solution follow the basic framework of SDM?

Has the thesis been completed?

- **Submission of final draft of master's thesis and materials formatted for publication *Details to be announced by the SDM Office.**

Submissions after the examination of the master's thesis:

<**Research-Intensive Course**> Final draft of master's thesis and materials formatted for publication

<**Learning-Intensive Course**> Final draft of master's thesis

These must be submitted regardless of whether revisions are required.

Follow the instructions of the examiners regarding revisions of the thesis, reexaminations, etc.

Students should consult with their primary research advisor regarding the format of the materials formatted for publication.

[Submission deadline] All submissions are to be made via the e-learning system approximately two weeks after the examination of the master's thesis. The submission deadlines are strictly enforced and late submissions will not be accepted. Furthermore, updates and revisions to submitted files are not permitted after the deadline. Any and all updates and revisions will be treated as an extension, even if carried out in error. *The SDM Office will provide details.

[How to submit] Upload the thesis to the e-learning system as a PDF/A file. The e-learning System does not accept any formats other than PDF/A, including Word files. *The URL and additional information will be provided by the SDM Office.

* Visit the "Master's degree information" page under "For Students" on the SDM website for details.
<http://www.sdm.keio.ac.jp/en/student/master/thesis.html>

3. Early Completion of the Master's Degree upon Fulfillment of the Program Requirements

Students should inform the SDM Office of their intention for early completion upon consultation with their research advisor no later than the deadline stated below:

<Application deadline> During the semester preceding the intended semester of degree completion

【How to apply】

Please apply by e-mail [To: SDM office / CC: academic counselor and your supervisor].

Required information:

- Student ID number, Name, Year(1st or 2nd), Course(RI or LI)
- Date of admission
- intention for early completion
- Preferred date for completion

6-3. Course Registration (Master's Program)

6-3-1. Course Registration

Students are expected to register all courses they wish to take through "Course Registration" on keio.jp during the designated registration period every semester. Please refer to the instructions below and complete registration. There is no limit on the number of courses which students can register each semester.

Before registering the courses you wish to take, check the online syllabi, and be sure to attend the classes held for them during the first week of the semester.

Students who fail to register courses during the designated period may be expelled in accordance with Article 161 of

the Graduate School Rules.

If you would like to leave the university temporarily without registering any courses, consult with your research advisor and submit an Application for Temporary Leave of Absence (休学願) to the SDM Office (for details, see “1. Temporary Leave of Absence” in the “Reports and Applications” section). The Application for Temporary Leave of Absence may be submitted even after registering courses. The deadline for submission is May 31 for the Spring Semester and November 30 for the Fall Semester.

6-3-2. Course Registration Procedures

Register all courses you wish to take through keio.jp; you will need your keio.jp ID and password to log in keio.jp (<http://keio.jp/>) during the designated period. Print out your completed course registration and keep it as a record until you receive your academic transcript, which is issued at the end of each semester.

6-3-3. Course Registration Schedule (Fall Semester)

Period for Online Class Registration:

(1) From 12:30 p.m. on Monday, September 27, 2021 until 4:45 p.m. on Wednesday, September 29, 2021. ※1

(2) From 6:00 p.m. on Thursday, September 30, 2021 until 10:00 a.m. on Friday, October 8, 2021. ※2

※1 Courses offered by other undergraduate faculties and graduate schools at Keio University must be registered during the period (1) above.

※2 During the period (2) above it is available to register and remove only SDM courses.

- Students must consult their research advisor (preferred research advisor for new students) before registering courses to make an effective study plan.

- Print and save a copy of the list of courses you have registered and submit a copy to your research advisor (preferred research advisor for new students).

Course confirmation:

- Confirmation must be completed after the course registration. If you discover that there are courses missing, please add them during the course amendment period below.

Course amendment period: From 10:00 a.m. on Thursday, October 21, 2021 until 4:45 p.m. on Friday, October 22, 2021

- Any amendments to the courses for which you have registered must be carried out during this period.

- Registered courses offered by other Keio graduate schools and undergraduate faculties can only be cancelled during this period if the graduate school or faculty concerned permits the cancellation of the course online. Courses offered by other Keio graduate schools and faculties cannot be added during this period. For more details, please refer to “F. Notes for Registering Courses Offered by Other Keio Graduate Schools” in the “IV. Notes” section below.

- Print and save a copy of the list of courses you registered.

Course amendment confirmation period:

- Confirmation must be completed after the course amendment. If you find any courses missing, please report this to the SDM Office by the above deadline.

- Changes to registered courses cannot be made after the designated period above.

6-3-4. Notes

A. Course Registration

- Check the course title, lecturers, and the five-digit registration number for each course. Please note that e-learning courses have different registration numbers to those offered in classrooms. Courses that hold classes over multiple class periods or days during the week only have one registration number.
- Once you have registered for a course, you cannot take other courses offered on the same day and class period.

B. “Column A”(A 欄申告) and “Column B”(B 欄申告) Registration

- Courses can be registered in either “Column A” or “Column B.” All registered courses will receive a grade, regardless of the column in which it has been registered. The difference between Column A and Column B is as follows:

Column A: Courses whose credits count towards the completion of the program must be registered in Column A.

Please register all courses offered by SDM in Column A. However, if a student decides to retake a course after having already earned credits, it can no longer be registered in Column A.

Column B: Courses whose credits do not count towards the completion of the program (Optional Courses) must be registered in Column B.

C. General Notes

- Register courses through “Course Registration” on keio.jp during the designated period every semester.
- Students who fail to register courses during the designated period may be expelled in accordance with Article 161 of the Graduate School Rules.
- Check your academic transcript for the previous semester for the courses you have completed. In particular, check for wrongly registered or unregistered courses, as these may prevent you from completing the degree program.
- Register all courses for the semester during the designated period. If registration is not completed, credits will not be awarded to students even if they take the examination.
- Check the subject group and/or subgroup (refer to 6-3-5. “Subject Number” Column) of each course before you register courses.
- After completing your registration, print out the list of registered courses, fill in the information of your research advisor (tentative research advisor or research supervisor for students who enrolled in September) on the upper right side, and submit it to the SDM Office by the due date. Please also keep a copy for your record with your class schedule.
- Please be aware that class schedules may change. Check the SDM website carefully before registering courses.

D. Notes for Registering Master’s Program Courses

- To take courses offered by SDM, register them in Column A (A 欄).
- Students enrolled in the Research-Intensive Course are required to take the “Research on System Design and Management” course given by their research advisor every semester. New students enrolled in the Research-Intensive Course should register for the “Research on System Design and Management” course during the course amendment period as they will not yet have been assigned a research advisor during the course registration period.
- Students enrolled in the Learning-Intensive Course are required to take the “Research on Project Design and Management” course given by their research advisor in the final semester of the degree program.
- Students who enroll in April must take the “Design Project” course in their first semester after enrollment. Students who enroll in September must take this course in their second semester (first spring semester after enrollment).
- Course registration is not required for “SDM RESEARCH METHODOLOGY” (for RI and LI students in the third semester)

- Students wishing to take courses offered by SDM as Optional Courses should register these in “Column B:11” (B 欄:11).
- Students wishing to take courses offered by other Keio graduate schools and undergraduate faculties should register these in “Column B:99” (B 欄:99).

E. Notes for Registering Courses Offered by Other Keio Graduate Schools

- If your research advisor thinks it will be beneficial for you to take courses offered by other Keio graduate schools or undergraduate faculties and gives his or her approval, you may take these courses as Optional Courses. Please note that credits earned for these courses do not count towards the completion of the degree program.

1. Registration Period

Please note that some Spring and Fall Semester courses offered by other Keio graduate schools and undergraduate faculties can only be registered during the Spring Semester course registration period. The registration procedures for courses offered by the Keio Business School (KBS) will be announced separately.

If you wish to take courses offered at two different campuses on the same day, you must allow a gap of at least one class period to travel between campuses. However, students may register for both second and third period courses offered on different campuses unless one of these is held at Shonan Fujisawa Campus (SFC).

2. Registration Procedures

Consult the lecturer prior to or during the first class for permission to take the course. The registration procedures for courses offered by the KBS will be announced separately.

3. Important Note When Registering Courses Online

Register courses offered by other Keio graduate schools and undergraduate faculties in Column B:99 (B 欄:99).

4. Restrictions on the Registrations of Students from other Graduate Schools

In principle, required courses, experiment and practical courses at other graduate schools and undergraduate faculties, and courses that are only offered to full-time students of a particular graduate school or faculty cannot be registered by SDM students.

List of courses that are not offered to other graduate school/faculty students:

<https://www.students.keio.ac.jp/en/com/class/registration/other-faculties.html>

5. Cancelling Registered Courses Offered by Other Keio Graduate Schools and Undergraduate Faculties

Registered courses offered by other Keio graduate schools and undergraduate faculties can only be cancelled during the course amendment period if the school or faculty concerned permits the cancellation of the course online.

Check the websites below for courses that cannot be cancelled. Courses offered by other Keio graduate schools cannot be added during the course amendment period.

<https://www.students.keio.ac.jp/en/com/class/registration/other-faculties.html>

F. Notes for Registering E-learning Courses

Prior permission from the lecturer is required to take core subjects by e-learning. Please note that **students who have newly graduated from an undergraduate faculty are not allowed to take core subjects via e-learning.**

- When registering, select the registration number for the e-learning courses. Please note that e-learning courses may require attendance in class for seminars when the class cannot be recorded on video. Additionally, makeup classes and discussion classes which are not part of e-learning may be held. For further information, please contact the lecturer.
- The maximum number of credits that can be earned through e-learning is:

Research-Intensive Course: 10 credits

Learning-Intensive Course: 30 credits (20 credits for students who enrolled in or before 2018)

If taking courses in excess of the maximum number of credits, the surplus will be treated as Optional Subjects (credit awarded will not count toward degree completion). Please register these courses in Column B.

- You cannot register to take a course both in class and by e-learning.

G. Academic Misconduct

Academic misconduct in regular or in-class examinations, reports, quizzes, or any other form of assessment will be severely penalized in accordance with Article 161 of the Graduate School Rules. Violation of this rule will not only result in students failing the course, but it may also result with a reprimand, demerit, suspension, or expulsion. Academic misconduct in written examinations includes cheating, taking an exam for another person or having someone take an exam for you, taking the exam paper out from the exam room, and failing to comply with the instructions of the course lecturer.

It should also be noted that plagiarism and the use of sources without acknowledging them in reports and theses are forms of academic misconduct.

Here are the most important points that students should be aware of when writing their reports and theses:

- a. Keep your own writing and your sources separate.
- b. When you cite or refer to someone else's texts or opinions, make sure to include a full reference of the source.
- c. Quote sources exactly as they appear in the original text, including misspellings.
- d. Citations must be done according to the established format.
- e. When you cite information found on the Internet, make sure to include the full URL, page title, and the date you copied the page in the citation information.

* If you use figures (including pictures, images, illustrations, etc.) and tables from another person's work or documents (including publications on the Internet) in your work, you must have permission to use it from the person who owns the copyright.

6-3-5. "Subject Number" Column

Each subject group and subgroup is assigned a subject number. Refer to the "Subject Number" column below when registering.

Note that the "Subject Number" column can only be assigned during the registration period or registration adjustment period.

Subject Number	Subject Group and/or Subgroup (as shown in academic transcript)	Subject Number for Column B
10-10-10	Master's Program: Core Subjects	-
10-10-20	Master's Program: Core Subjects (e-learning)	-
10-20-10	Master's Program: Special Research Subjects	-
10-30-10	Master's Program: Project Subjects	-
20-10-10	Master's Program: Major Courses	-
20-10-20	Master's Program: Major Courses (e-learning)	-
90-10-10	Optional Courses: Master's program courses offered at the Graduate School of System	11

	Design and Management	
90-10-20	Optional Courses: Courses offered at other graduate schools and undergraduate faculties	99

6-3-6. Inquiries on the Curriculum

Please consult your research advisor or academic counselor if you have any questions. For technical matters regarding online course registration and related problems, consult with the SDM Office.

7. Curriculum and Process for Degree Completion (Doctoral Program)

The numbers in the brackets specify the credits awarded for the course.

7-1. Required Course

Advanced Research on System Design and Management (2)

The credits for this course are awarded based on the supervision of the doctoral dissertation, and there are no timetabled classes. Students may register for the Core Subjects of the master’s program and the “Design Project” course when necessary. Students should consult with their research advisor for further details.

7-2. Requirements for Completion of Degree

A. Degrees Awarded by SDM

Doctoral Degree (System Engineering)

Doctoral Degree (System Design and Management)

B. Requirements for Degree Completion

1. Be enrolled at SDM for six or more semesters, excluding temporary leaves of absence.
2. Earn credits in accordance with the requirements set forth in Article 108 Section 41 of the Graduate School Rules.
3. Pass the doctoral dissertation and final examination.

(Excerpt from the Graduate School of Rules)

Article 108 Section 41

1. To fulfill the requirements for a doctoral degree, a student must earn at least 12 credits from courses as specified in Article 108 Section 36-1 and satisfy the requirements specified in Article 109.
2. The final examination shall center on the defense of the doctoral dissertation.
3. Notwithstanding the provisions of the preceding two sections, separate provisions shall be made for cases of early degree completion.

Article 108, Section 42

1. Three copies of the dissertation are to be prepared and submitted to the Graduate School of System Design and Management Committee via the research advisor of the student.
2. The reviews and defense of the dissertation shall be completed within one year of receipt.

C. Process for Completing Degree

*For more information about prescribed forms, Completion Guide, and how to make up the documents, check out the SDM website "For Students" → "Doctoral degree application procedures".

1. Schedule

Degree completion	Sept. 2021	Mar. 2022
Preparation of exam by the primary examiner and candidates for the secondary examiners	by the day before the application for degree examination is submitted.	

Application for degree examination (completed set of application materials and soft bound copy of dissertation)	3p.m. on July 5, 2021	3p.m. on Dec. 20, 2021
Acceptance of application for degree examination and establishment of the examination committee	July 7, 2021	Dec. 22, 2021
Preliminary examination	Early July, 2021	Early Jan., 2022
Final examination (public hearing, confirmation of level of scholarship, and language skills)	Early Aug., 2021	Early Feb. 2022
Submission of doctoral dissertation (two hard bound copies)	3p.m. on Aug. 23, 2021	3p.m. on Feb. 28, 2022
Announcement of students who have completed the doctoral program	Sept. 3., 2021	Mar. 10, 2022

The above schedules are subject to change.

2. Application for degree examination

A completed set of application materials is to be submitted to the SDM Office.

[Documents required for application]

- a. “Degree Application Form” (学位申請書; prescribed Word-based form) 1 copy
- b. “Summary of Doctoral Dissertation” (主論文要旨; prescribed Word-based form) 1 copy
- c. “Dissertation index” (論文目録; prescribed Word-based form) 1 copy *refer to the “Completion Guide” (SDM website)
- d. Personal history (prescribed Word-based form) 1 copy
- e. Relevant publications 1 set (bound in an A4 file with the paper titles and your name indicated on the front cover and spine)
- f. Soft bound copies of dissertation (A4) multiple copies (1 copy for the proposed primary examiner and 1 copy for each of the proposed secondary examiners)

[Notes on application documents]

*These documents have been created based on the formats specified in the Rules and Regulations for Degree Conferral. Do not for any reason delete sections of the prescribed forms and complete in accordance with the following:

*Indicate all years in the Western calendar for documents a. through d.

*Ensure that the title of the dissertation is consistent for all of the application documents and the proposal submitted by the primary examiner.

*Use your full name in the application documents.

(Use official kanji and not abbreviated forms. This application will be the basis of your diploma that will be presented at the commencement ceremony.)

a. Degree Application Form (学位申請書)

- In the parentheses () in the 1st line of the application, enter the type of degree being sought (System Engineering or System Design and Management). Students must obtain the approval of their research advisor in advance.

- In the date column at the top of the application, enter the date that the application will be submitted to the SDM Office.
- Students must affix their official seal once the form has been completed. Signatures are acceptable for non-Japanese nationals who do not have an official seal.

b. Summary of Doctoral Dissertation (主論文要旨)

- Roughly 300 words.

c. Dissertation index (論文目録)

- “Remark 1” and “Remark 2” contain notes on the dissertation. “Remark 1” does not apply to SDM.
- The “dissertation index (Completion Guide)” contains the standard orthography for relevant publications. This orthography may be changed if unsuitable for the research for which the degree is being sought. Students should consult with their primary examiner in such cases.
- In the “Report No.” column at the top of the form, circle the appropriate designation (A or B) and leave the space for the number blank.
- Secondary papers are not subject to examination at SDM. Indicate “0” as the number of copies and leave the column for secondary paper titles blank.
- In the “relevant publications” column, leave the number of copies blank and fill out the rest of the information that is required as shown in the sample.
- If the “dissertation index” requires two pages, indicate “(1/2)” in the margin on the first page and “(2/2)” in the margin on the second page. Do not use double-sided printing.

d. Personal history

- In the “Report No.” column at the top of the form, circle the appropriate designation (A or B) and leave the space for the number blank.
- Students should use the same official seal that was used for the “Degree Application Form.” Signatures are acceptable for non-Japanese nationals who do not have an official seal.
- Fill in the entrance and completion dates as indicated below.

< Students currently enrolled in a doctoral program at Keio University should write their expected date of completion as follows on their personal history >

When completion of the degree is scheduled for March, write “Completion expected on March 23.” If scheduled to leave after earning all of the required credits in March, write “Scheduled to leave after earning all required credits on March 31.”

When completion of the degree is scheduled for September, write “Completion expected on September 21.” If scheduled to leave after earning all of the required credits in September, write “Scheduled to leave after earning all of the required credits on September 21.”

e. List of relevant publications, etc. (A4)

Submit prints of all of your published papers relating to the dissertation (copies accepted), copies of abstracts for conference presentations, and any other related documents in an A4 file (ordinary paper file, etc.) in the order listed in the “dissertation index”, and indicate the paper titles and your name on the front cover and spine.

3. Submission of Bound Copy of Doctoral Dissertation

[Documents to be submitted]

- a. Bound copy of Doctoral Dissertation (2 copies)

- b. Electronic file of Doctoral Dissertation (PDF/A file)
- c. Summary of Doctoral Dissertation (主論文要旨; PDF/A file)
- d. Request for Approval Regarding Release of Doctoral Dissertation (Prescribed form 1 copy)
- e. Doctoral Dissertation Consent Form (Prescribed form 1 copy)

* When the complete text of your thesis cannot be made public due to unavoidable circumstances, please submit the thesis abstract and one hardbound copy of the thesis to the SDM Office in addition to the above.

[Submission to] SDM Office

D. Research presentations * Details to be announced by the SDM Office.

[Date] Students enroll in April: February 12, 2022 / Students enroll in September: September 18, 2021

[Presentation time]

Total of 20 minutes per student (12 minutes to present and 8 minutes for Q&A)

[Advance submissions]

a. Materials formatted for publication.

*Submission of incomplete materials are acceptable at the time of the presentation if the progress of research and related issues are clearly stated.

b. Presentation slides (PPT file).

[How to submit] Upload to the e-learning system.

[Submission deadline] In principle, by 23:59 on the day prior to the presentation.

The presentations should be on the results of the research so far and future plans.

The presentations will take place in three rooms and all students should be in attendance at one of these venues in order to listen to and discuss the presentations of other students.

* The URL and additional information will be provided by the SDM Office.

[Notes]

* Presentations are held each academic year.

*The presentation is to be conducted in either Japanese or English.

*The presentation manuscript and abstract must be checked by the research advisor prior to the presentation.

*All students must attend the presentations of other students in one of the three rooms hosting the event.

*On the day of the presentations, a PC with the presentation files of all students in each room must be prepared to ensure that the event proceeds smoothly.

*The SDM Office will announce the order of the presentations.

7-3. Course Registration (Doctoral Program)

7-3-1. Course Registration

Students are expected to register all courses they wish to take through “Course Registration” on keio.jp during the designated registration period every semester. Please refer to the instructions below and complete registration. There is no limit on the number of courses which students can register each semester.

Before registering the courses you wish to take, check the online syllabi, and be sure to attend the classes held for them during the first week of the semester.

Students who fail to register courses during the designated period may be expelled in accordance with Article 161 of

the Graduate School Rules.

If you would like to leave the university temporarily without registering any courses, consult with your research advisor and submit an Application for Temporary Leave of Absence (休学願) to the SDM Office (for details, see “2-1. Temporary Leave of Absence” in the “Reports and Applications” section). The Application for Temporary Leave of Absence may be submitted even after registering courses. The deadline for submission is May 31 for the Spring Semester and November 30 for the Fall Semester.

7-3-2. Course Registration Procedures

Register all courses you wish to take through “Course Registration” on keio.jp; you will need your keio.jp ID and password to log in keio.jp (<http://keio.jp/>) during the designated period. Print out your completed course registration and keep it as a record until you receive your academic transcript, which is issued at the end of each semester.

7-3-3. Course Registration Schedule (Fall Semester)

Period for Online Class Registration:

(1) From 12:30 p.m. on Monday, September 27, 2021 until 4:45 p.m. on Wednesday, September 29, 2021 ※1

(2) From 6:00 p.m. on Thursday, September 30, 2021 until 10:00 a.m. on Friday, October 8, 2021. ※2

※1 Courses offered by other undergraduate faculties and graduate schools at Keio University must be registered during the period (1) above.

※2 During the period (2) above it is available to register and remove only SDM courses.

- Students must consult their research advisor (preferred research advisor for new students) before registering courses to make an effective study plan.

- Print and save a copy of the list of courses you have registered and submit a copy to your research advisor (preferred research advisor for new students).

Course confirmation period:

- Confirmation must be completed during this period. If you discover that there are courses missing, please add them during the course amendment period below.

Course amendment period: From 10:00 a.m. on Thursday, October 21, 2021 until 4:45 p.m. on Friday, October 22, 2021

- Any amendments to the courses for which you have registered must be carried out during this period.

- Registered courses offered by other Keio graduate schools and undergraduate faculties can only be cancelled during this period if the graduate school or faculty concerned permits the cancellation of the course online. Courses offered by other Keio graduate schools and faculties cannot be added during this period. For more details, please refer to “F. Notes for Registering Courses Offered by Other Keio Graduate Schools” in the “IV. Notes” section below.

- Print and save a copy of the list of courses you registered.

Course amendment confirmation period:

- Confirmation must be completed during this period. If you find any courses missing, please report this to the SDM Office by the above deadline.

- Changes to registered courses cannot be made after the designated period above.

7-3-4. Notes

A. Course Registration

- Check the course title, lecturers, and the five-digit registration number for each course. Please note that e-learning courses have different registration numbers to those offered in classrooms. Courses that hold classes over multiple class periods or days during the week only have one registration number.
- Once you have registered for a course, you cannot take other courses offered on the same day and class period.

B. “Column A”(A 欄申告) and “Column B”(B 欄申告) Registration

- Courses can be registered in either “Column A” or “Column B.” All registered courses will receive a grade, regardless of the column in which it has been registered. The difference between Column A and Column B is as follows:

Column A: Courses whose credits count towards the completion of the program must be registered in Column A.

Please register all courses offered by SDM in Column A. However, if a student decides to retake a course after having already earned credits, it can no longer be registered in Column A.

Column B: Courses whose credits do not count towards the completion of the program (Optional Courses) must be registered in Column B.

C. General Notes

- Register courses through “Course Registration” on keio.jp during the designated period every semester.
- Students who fail to register courses during the designated period may be expelled in accordance with Article 161 of the Graduate School Rules.
- Check your academic transcript for the previous semester for the courses you have completed. In particular, check for wrongly registered or unregistered courses, as these may prevent you from completing the degree program.
- Register all courses for the semester during the designated period. If registration is not completed, credits will not be awarded to students even if they take the examination.
- Check the subject group and/or subgroup (refer to 7-3-5. “Subject Number” Column) of each course before you register courses.
- After completing your registration, print out the list of registered courses, fill in the information of your research advisor (tentative research advisor or research supervisor for students who enrolled in September) on the upper right side, and submit it to the SDM Office by the due date. Please also keep a copy for your record with your class schedule.
- Please be aware that class schedules may change. Check the SDM website carefully before registering courses.

D. Notes for Registering Doctoral Program Courses

- Register the “Advanced Research on System Design and Management” course offered by your research advisor each semester.
- Students wishing to take courses offered in the SDM Master’s Program should register these in Column B:11 (B 欄:11).
- Students wishing to take courses offered by other Keio graduate schools and undergraduate faculties should register these in Column B:99 (B 欄:99).

E. Notes for Registering Courses Offered by Other Keio Graduate Schools

- If your research advisor thinks it will be beneficial for you to take courses offered by other Keio graduate schools or undergraduate faculties and gives his or her approval, you may take these courses as Optional Courses. Please note that credits earned for these courses do not count towards the completion of the degree program.

1.Registration Period

Please note that some Spring and Fall Semester courses offered by other Keio graduate schools and undergraduate faculties can only be registered during the Spring Semester course registration period. The registration procedures for courses offered by the Keio Business School (KBS) will be announced separately. If you wish to take courses offered at two different campuses on the same day, you must allow a gap of at least one class period to travel between campuses. However, students may register for both second and third period courses offered on different campuses unless one of these is held at Shonan Fujisawa Campus (SFC).

2.Registration Procedures

Consult the lecturer prior to or during the first class for permission to take the course. The registration procedures for courses offered by the KBS will be announced separately.

3.Important Note When Registering Courses Online

Register courses offered by other Keio graduate schools and undergraduate faculties in Column B:99 (B 欄:99).

4.Restrictions on the Registrations of Students from other Graduate Schools

In principle, required courses, experiment and practical courses at other graduate schools and undergraduate faculties, and courses that are only offered to full-time students of a particular graduate school or faculty cannot be registered by SDM students.

List of courses that are not offered to other graduate school/faculty students:

<https://www.students.keio.ac.jp/en/com/class/registration/other-faculties.html>

5. Cancelling Registered Courses Offered by Other Keio Graduate Schools and Undergraduate Faculties

Registered courses offered by other Keio graduate schools and undergraduate faculties can only be cancelled during the course amendment period if the school or faculty concerned permits the cancellation of the course online.

Check the websites below for courses that cannot be cancelled. Courses offered by other Keio graduate schools cannot be added during the course amendment period.

<https://www.students.keio.ac.jp/en/com/class/registration/other-faculties.html>

F. Notes for Registering E-learning Courses

- If you are unable to attend every class but have a strong desire to take the course, you may register for the e-learning course.
You can view lectures and earn credits by submitting assignments through the e-learning system. However, **prior permission from the lecturer is required to take core subjects by e-learning**. Please note that **students who have newly graduated from an undergraduate faculty are not allowed to take core subjects via e-learning**.
- When registering, select the registration number for the e-learning courses. Please note that e-learning courses may require attendance in class for seminars when the class cannot be recorded on video. Additionally, makeup classes and discussion classes which are not part of e-learning may be held. For further information, please contact the lecturer.
- You cannot register to take a course both in class and by e-learning.

G. Academic Misconduct

Academic misconduct in regular or in-class examinations, reports, quizzes, or any other form of assessment will be severely penalized in accordance with Article 161 of the Graduate School Rules. Violation of this rule will not only result in students failing the course, but it may also result with a reprimand, demerit, suspension, or expulsion. Academic misconduct in written examinations includes cheating, taking an exam for another person or having someone take an exam for you, taking the exam paper out from the exam room, and failing to comply with the instructions of the course

lecturer.

It should also be noted that plagiarism and the use of sources without acknowledging them in reports and theses are forms of academic misconduct.

Here are the most important points that students should be aware of when writing their reports and theses:

- a. Keep your own writing and your sources separate.
- b. When you cite or refer to someone else's texts or opinions, make sure to include a full reference of the source.
- c. Quote sources exactly as they appear in the original text, including misspellings.
- d. Citations must be done according to the established format.
- e. When you cite information found on the Internet, make sure to include the full URL, page title, and the date you copied the page in the citation information.

* If you use figures (including pictures, images, illustrations, etc.) and tables from another person's work or documents (including publications on the Internet) in your work, you must have permission to use it from the person who owns the copyright.

7-3-5. "Subject Number" Column

Each subject group and subgroup is assigned a subject number. Refer to the "Subject Number" column below when registering.

Note that the "Subject Number" column can only be assigned during the registration period or registration adjustment period.

Subject Number	Subject Group and/or Subgroup (as shown in academic transcript)	Subject Number for Column B
50-10-10	Doctoral Program: Special Research Subjects	-
90-10-10	Optional Courses: Master's program courses offered at the Graduate School of System Design and Management	11
90-10-20	Optional Courses: Courses offered at other graduate schools and undergraduate faculties	99

7-3-6. Inquiries on the Curriculum

Please consult your research advisor or academic counselor if you have any questions. For technical matters regarding online course registration and related problems, consult with the SDM Office.

Layout of the Third Floor of the Collaboration Complex

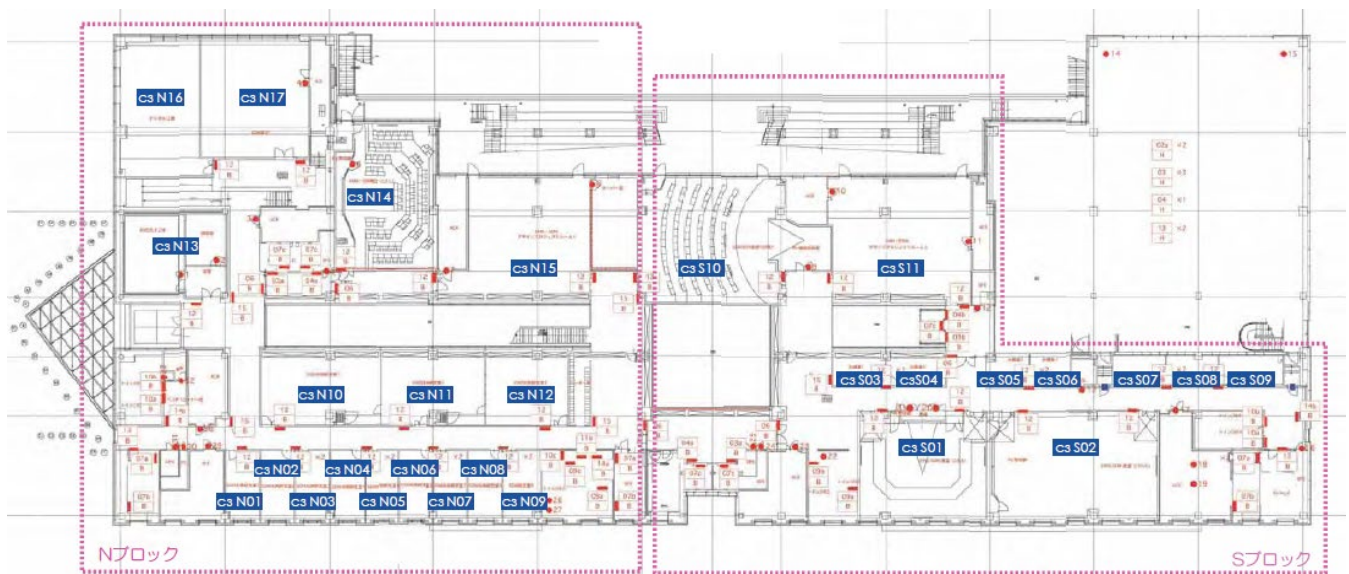

C3N01-N03	[SDM] Individual Research Space	C3S01	[KMD] Classroom
C3N04-N09	[SDM] Discussion Room for Master's Students	C3S02	[KMD] Classroom
C3N10-N12	[KMD] Joint Research Laboratory	C3S03-S09	[SDM/KMD] Discussion Room
C3N13	[KMD] Studio	C3S10	[SDM] Classroom
C3N14	[SDM] Classroom	C3S11	[KMD] Discussion Room for Master's Students
C3N15	[SDM] Discussion Room for Master's Students		
C3N16	[KMD] Joint Research Laboratory		
C3N17	[SDM] Laboratory		

Layout of the Sixth Floor of the Collaboration Complex

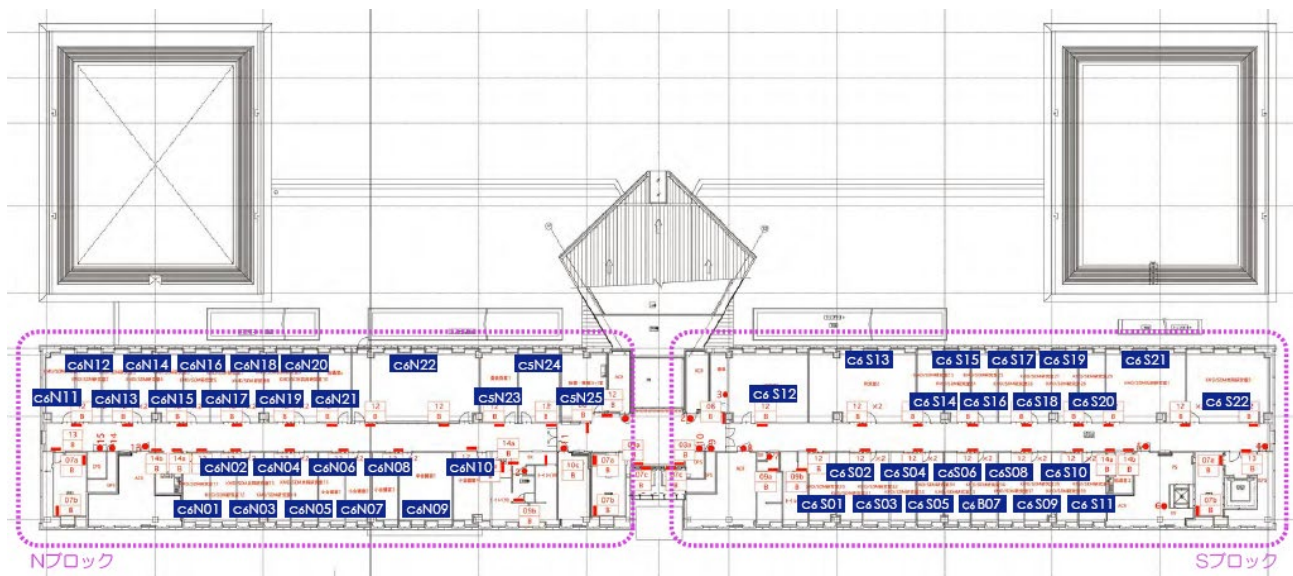

C6N01	Yoshiki YAMAGATA	C6N08		C6N17	Naohiko KOHTAKE
C6N02	Tetsuro OGI	C6N11	Takashi MAENO	C6N18	Naoko TANIGUCHI
C6N03		C6N12	Shinichiro HARUYAMA	C6N19	Testuya TOMA
C6N04	T.YASUI / A.YOSHIDA	C6N13	Seiko SHIRASAKA	C6N20	Makoto IOKI
C6N05		C6N14	Tomohiko TANIGUCHI	C6N21	Secretarial Room
C6N06	Hidekazu NISHIMURA	C6N15	K. HIRAKO	C6N24	Dean's Room
C6N07	Masahiro NIITSUMA	C6N16	K.ISHIBASHI / Y.TOMITA / K.WATANABE	C6S01	Executive Advisor of SDM Research Institute's Room
				C6S20	Part-time Lecturer's Room
				C6S12	SDM Laboratory

Campus Map



1. Hiyoshi Library
2. Fourth Building Section A (J411-J447)
3. Fourth Building Section B (J11-39, Seminar Rooms 3 and 4)
4. Fourth Building Independence Wing (DB105-DB203, D101-D413, Hiyoshi Communication Lounge)
5. Sixth Building (J611-642, Seminar Rooms 1 and 2, Green's Terrace)
6. Third Building (301-336)
7. Jukusei Kaikan Student Union Building (Training Room, Club Rooms)
8. Cafeteria Building (Student Cafeteria, Club Rooms)
9. Raiosha (Faculty Office, Meeting Rooms, Symposium Space)
10. University Co-op
11. Fujiyama Memorial Hall (F01-F11, Meeting Rooms)
12. Seventh Building (701, 703, 704)

13. Second Building (214, 221, 224, 231, 234)
14. Gymnasium (Judo and Kendo Hall)
15. Sports Building (Institute of Physical Education, Table Tennis Courts)
16. Eighth Building (811, 812, 831)
17. Hiyoshi Commemorative Hall
18. First Building (Senior High School)
19. Sports Medicine Research Center
20. Health Center
21. Senior High School Gymnasium
22. Senior High School Judo Gymnasium
23. Collaboration Complex (Library, Faculty Lounge, Fujiwara Hiroshi Hall, Child Care Center, Fitness Club, Cafe, Restaurant, Convenience Store)